

Instruction Bulletin

Replaces 80043-725-02 01/2008

ENGLISH

H- or J-Frame Main Circuit Breaker and Adapter Kit Installation onto an NQ Panelboard Class 1640

Retain for future use.

Introduction

This bulletin contains instructions on installing a Square D® brand H- or J-frame main circuit breaker (maximum of 150 A for H-frame and 250 A for J-frame) and adapter kit onto a Square D brand NQ panelboard manufactured by Schneider Electric.

Safety Precautions

⚠ DANGER

HAZARD OF ELECTRIC SHOCK, EXPLOSION, OR ARC FLASH

- Apply appropriate personal protective equipment (PPE) and follow safe electrical work practices. See NFPA 70E.
- This equipment must only be installed and serviced by qualified electrical personnel.
- Turn off all power supplying this equipment before working on or inside equipment.
- Always use a properly rated voltage sensing device to confirm power is off.
- Replace all devices, doors and covers before turning on power to this equipment.

Failure to follow these instructions will result in death or serious injury.

Kit Contents

NQMB2HJ and NQMB2HJ14

- A. Main circuit breaker deadfront cover (1)
- B. Main circuit breaker mounting pan (1)
- C. **NQMB2HJ kit only**–
Deadfront support brackets (2)
- D. **NQMB2HJ14 kit only**–
Deadfront support brackets (2)
- E. 10-32 x 7/16-inch tapping screws (2)
- F. 10-32 x 5/16-inch tapping screws (6)
- G. 8-32 x 3 1/4-inch tapping screws (2)
- H. 1/4-20 x 7/8-inch tapping screws (3)
- I. Terminal kit no. S37444 for main breaker–
catalog number beginning with H (1)
- J. Terminal kit no. S37445 for main
breaker–catalog number beginning with J (1)
- K. Hard bus circuit breaker connectors (3)
- L. “MAIN” circuit breaker label (1)

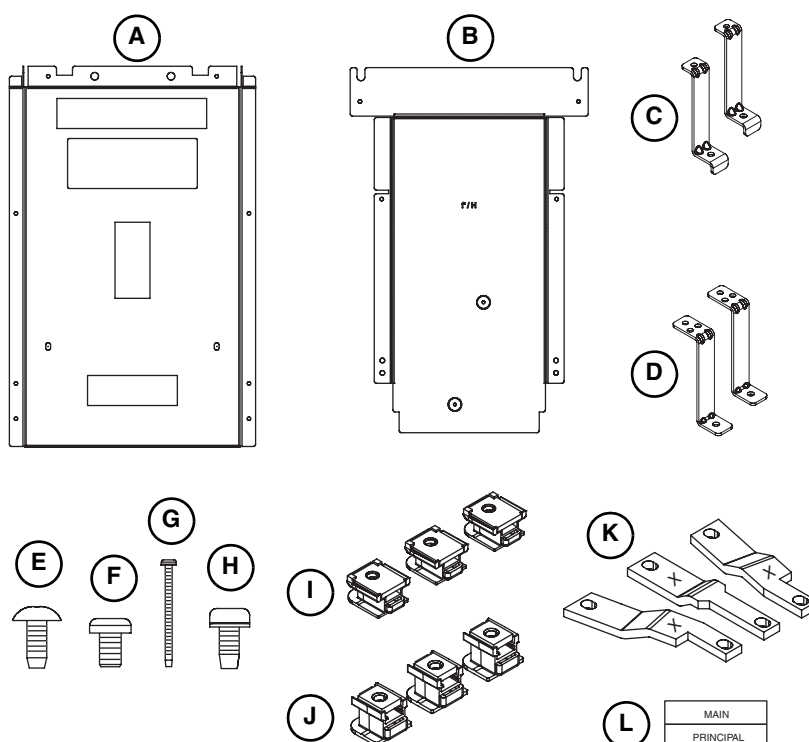

NOTE: Kit contents not shown to scale.

Tools Needed



- #2 Square-head Robertson driver
- Slotted-head screwdriver
- Torque wrench with 5/32-inch Allen driver



Turn off all power supplying this equipment before working inside the panelboard; follow all lockout/tagout procedures.

Installing a Main Circuit Breaker and Adapter Kit

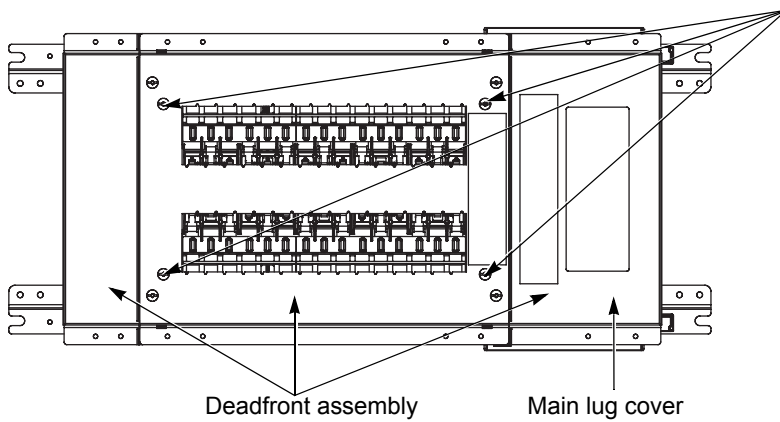

1 Remove the deadfront assembly and retain the four screws for reuse.

2 Remove the line lugs from the panel bus.
Discard the lugs and the screws.

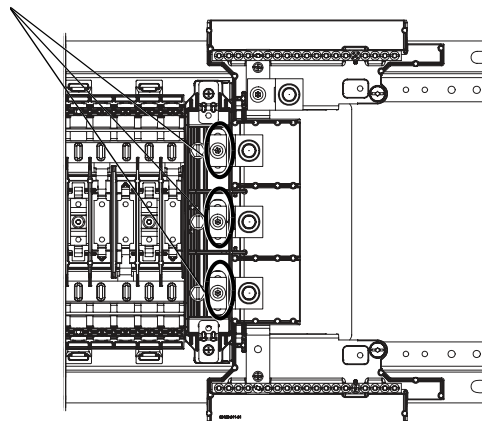

3 Attach the main circuit breaker mounting pan to the main lug end of the panelboard using four 10-32 x 5/16-inch tapping screws included in the kit.

4 For installing the NQMB2HJ kit:

Attach the two deadfront support brackets to the alignment slots on the main circuit breaker mounting pan (with the top of the brackets pointing to the panelboard) using the remaining two 10-32 x 5/16-inch tapping screws included in the kit.

For installing the NQMB2HJ14 kit:

Attach the two deadfront support brackets to the main circuit breaker mounting pan (with the top of the brackets pointing inward, as shown) using the remaining two 10-32 x 5/16-inch tapping screws included in the kit.

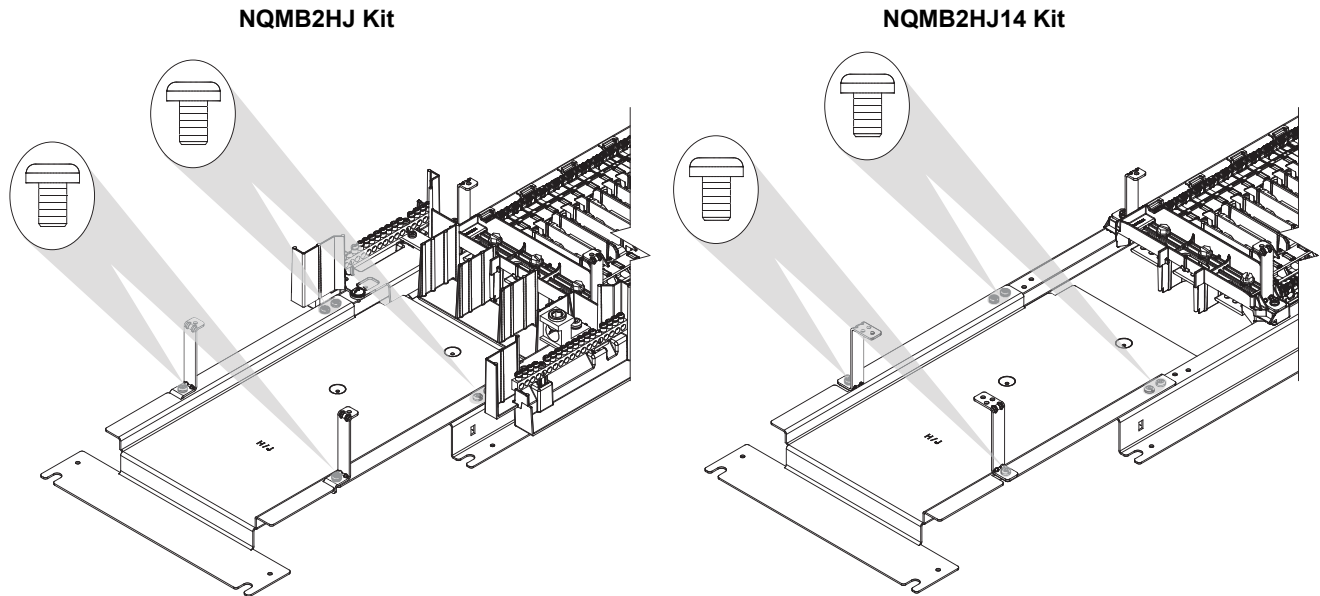

Connecting a Main Circuit Breaker to Panelboard Bus Structure

5 NOTE: Ensure that the breaker is located so that the “ON” end is always toward the top of the panelboard.

Remove the lugs from the end of the circuit breaker that will be connected to the panel. With the slotted screwdriver, insert the blade into the terminal slot under the breaker lug and pry outward. Discard the lug assembly.

NOTE: NQMB2HJ kit shown.

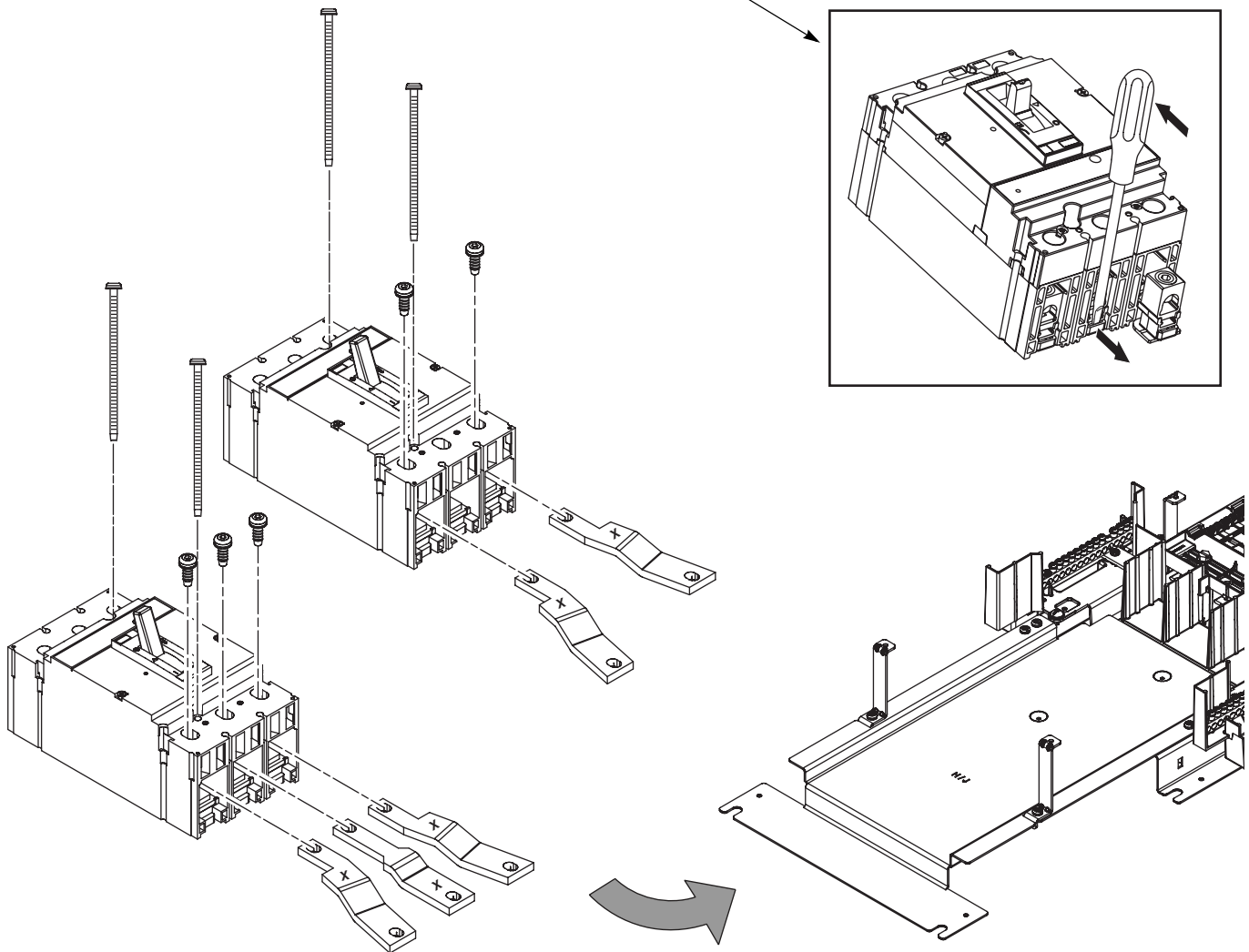

6 Choose terminal nut kits as follows:

- For main breakers with catalog numbers beginning with H, choose S37444
- For main breakers with catalog numbers beginning with J, choose S37445

Following the instructions in the terminal kit, insert the terminal kit into the circuit breaker. Discard the unused kit.

7 Attach the hard bus circuit breaker connectors loosely to the circuit breaker using the screws provided in the terminal kit. The “X” mark on the hard bus connector identifies the top surface. Do not tighten the screws until step 11.

NOTE: For a single-phase panelboard, the B-phase connector is not required.

8 NOTE: Discard the screws supplied with the breaker.

Install the main circuit breaker on the mounting pan using the two 8-32 x 3 1/4-inch tapping screws included in the kit.

- 9** Attach the hard bus circuit breaker connectors loosely to the panel bus using the three 1/4-20 x 7/8-inch tapping screws included in the kit.

NOTE: NQMB2HJ kit shown. Example shown is for three-phase applications.

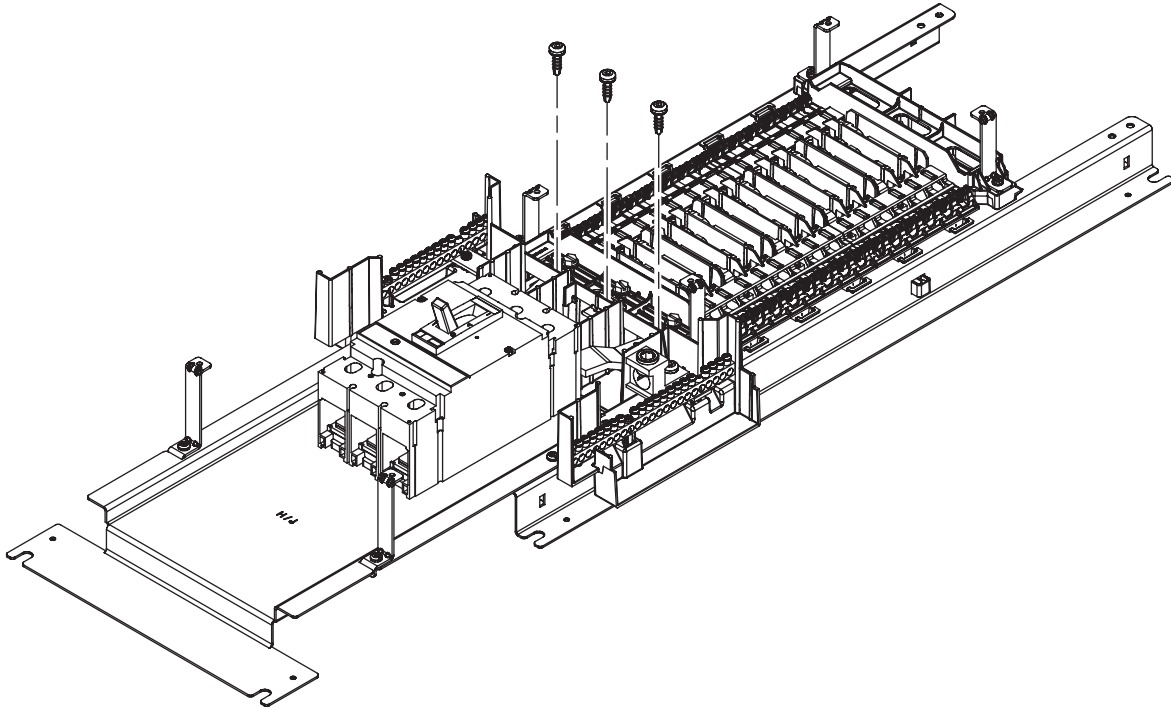

- 10** **NOTE: Do not overtighten the screws.**

Tighten all screws from step 10 to 25–30 lb-in (2.8–3.4 N•m).

- 11** Refer to the terminal kit instructions for the appropriate hard bus circuit breaker connector torque value.

- 12** Remove the existing main lug deadfront cover (see step 1) and discard, but retain the two screws. Mount the main circuit breaker deadfront cover included in the kit using the same screws.

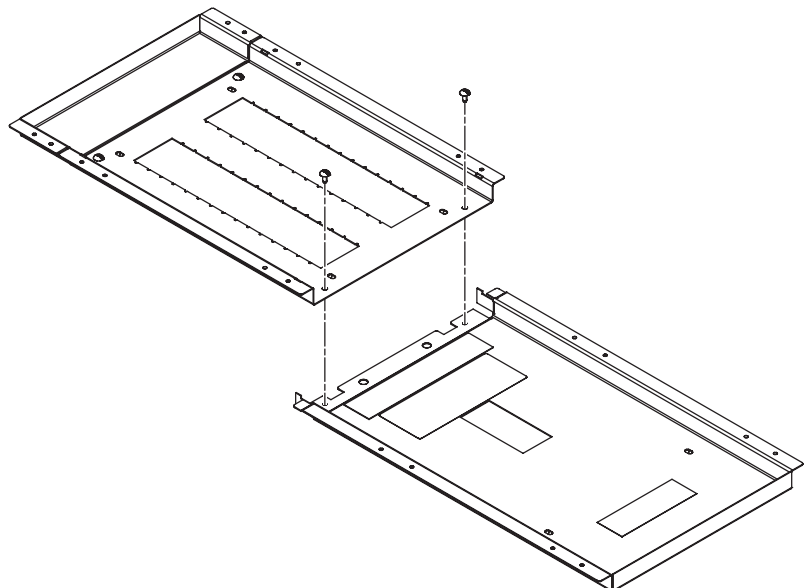

- 13** Remount the deadfront assembly using the four screws retained from step 1 and the two 10-32 x 7/16-inch tapping screws provided in the kit.

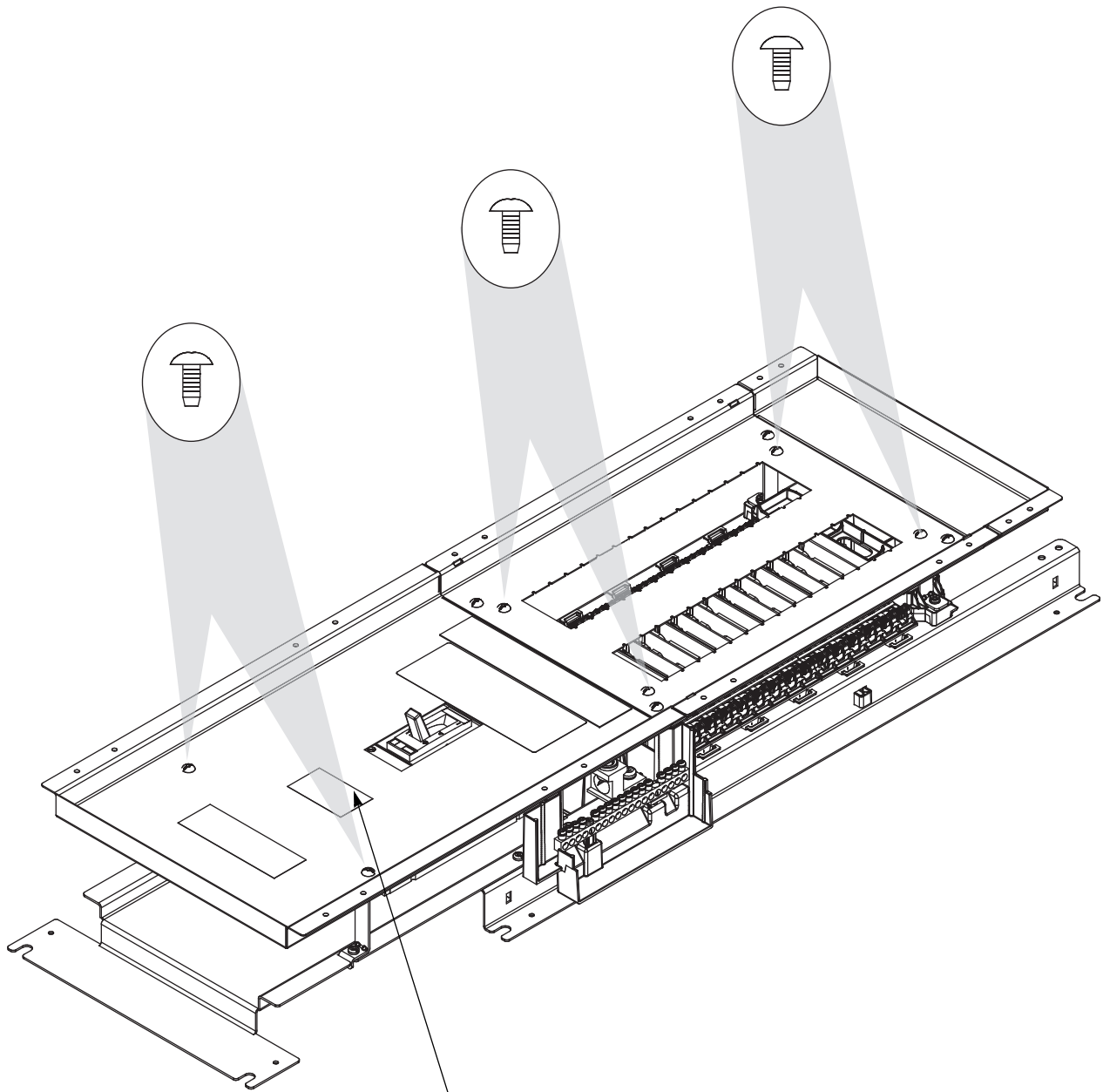

- 14** Peel off the backing of the “MAIN” circuit breaker label. Apply it to the cover near the circuit breaker handle.



For technical support on the installation of this kit, contact the Square D / Schneider Electric Customer Information Center at 1-888-SquareD (1-888-778-2733).

Schneider Electric USA
252 North Tippecanoe
Peru, IN 46970 USA
1-888-SquareD (1-888-778-2733)
www.us.SquareD.com

Square D® is a trademark or registered trademark of Schneider Electric. Other trademarks used herein are the property of their respective owners.

Electrical equipment should be installed, operated, serviced, and maintained only by qualified personnel. No responsibility is assumed by Schneider Electric for any consequences arising out of the use of this material.