



Harmony+ FAQ v9.1

FAQ summary

« Click » on the topic targeted

[How to access to the customization tool](#)

[What is saved during customization](#)

[Warning: Download your files for a future usage 1/2/3](#)

[Color plated products : what are the available colors](#)

[In what environment can I use the legend panel 1/2](#)

[Can a legend panel be cut with a laser cutting](#)

[Customization & limitations](#)

[What is the good size for the definitions of pictures](#)

[How do I import my logo without a background](#)

[Transparency Management 1/2/3](#)

[Icon Library](#)

[Custom Cutouts](#)

[How can I select 2 elements to align them](#)

[How do I group 2 buttons to make a motor start/stop panel](#)

[Control station : my text is not in the good direction](#)

[Why can't I save my legend panel due to conflict between elements](#)

[I want to do a hatched round rectangle](#)

[Last news customization : other functions improvements 1/2](#)

[I can't finish my drawing 1/2](#)

[Images on pilot's lights diameter 22. Advice](#)

[Can I use the legend panel to get a multi-language e-stop marking 1-15](#)

How to access to the customization tool

- From the selector, three ways exist :

22 mm Pushbutton

Browse by Ranges (3)



Harmony XB4

Ø 22 mm modular metal pushbuttons, switches, and pilot lights. The modular range of Ø 22 mm metal control and signaling units combines...

Part of **Harmony**

[View Products >](#)

[Launch Product Selector >](#)

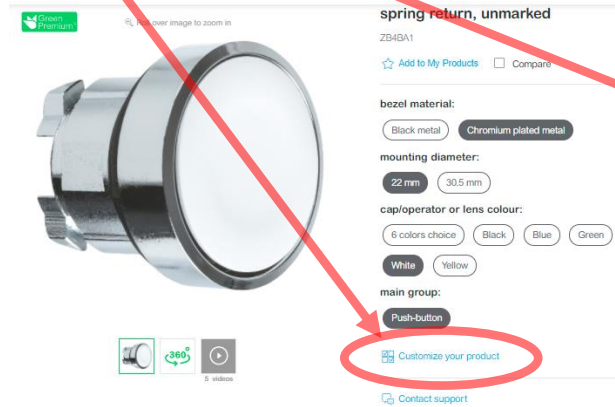

Harmony XB4

Ø 22 mm modular metal pushbuttons lights

Part of **Harmony**

The modular range of Ø 22 mm metal control and signaling units combines modern standard and flush mounted designs with a high level of customization to meet most industrial

[Select and Customize](#)

[Contact support](#)

- With an existing UID in selector screen

ZB4-2011GQQN3

OK



Dn

Is the customer's name saved for customization ?

How do we find back data about a specific customization ?

- Customer names are not saved anywhere
 - Because the configurator is installed in Distributor website and there is legal issues to share personal data (GDPR, German local law...)
- The only saved data is the specific customization number
 - Customers need to archive them if they need to re-order
 - Customers sharing or not sharing this customization number is the only protection of customization content against re-ordering
 - So, the end-user needs to get it from the OEM if they want to do maintenance or, they need to re-do a new similar customization from scratch
 - Customers can possibly ask their distributors to find back the customization number within their ordering history, depending on distributor ordering system

Warning 1/3

! Don't forget to record your current work (json file)

Select your Harmony XB4

Return to Selector Button ZB4FA2 Internal reference: ZB4FACUST01 Your customization ID: ZB4-2011FK9RR Add To Cart Duplicate

Image Preview
As it looks in the editor
Download Customization File
You will be able to import this file

MACHINE1
DO

Today (1)

Download files :

HPC_Configuration_[20201126].json

26/11/2020 09:19

JSON File

Warning 2/3

« Click » to return to the summary

When you want to go back to your customization, download the « json » file, that's it.

Select your Harmony XB4

Pushbutton Control box

Enter your customization ID OK

Select your device to configure

Pushbutton Mushrooms Emergency stop pushbutton

Warning 3/3

! Don't forget to complete your customization before ordering the product (complete button), if not no possible to order !

Select your Harmony XB4

Return to Selector Button ZB4BW5337

Internal reference: ZB4BWCUST08 Your customization ID: ZB4-2011GQQN3

Complete

Clear All

PICTOGRAM

36







TEXT

DDD

Arial Rounded

Color plated products : what are the available colors ?

« Click » to
return to the
summary

Color	Official Schneider name	Closest color definition	Hexadecimal code	RGB coordinates	Existing product with similar color
	SE Spruce Green	Pantone 355 C	#009639	RGB (0, 150, 57)	New green pushbutton
	SE Living White	RAL 9003	#ecece7	RGB (236, 236, 231)	White pushbutton
	SE Black	RAL 9005	#2d2926	RGB (14, 14, 16)	Black pushbutton
	SE Blue	Pantone 298 C	#41b6e6	RGB (65, 182, 230)	New blue pushbutton
	SE Sunflower Yellow	Pantone 109 C	#ffd100	RGB (255, 209, 0)	XB5 e-stop body
	Red	Pantone 1795 C	#d22630	RGB (210, 38, 48)	E-stop mushroom head
	Purple	RAL 4005	#76689a	RGB (118, 104, 154)	/
Metal look	Stainless steel grey	Pantone 424C / RAL 9023	/	/	/
Metal look	Titanium	Pantone 415 C / RAL 7030	/	/	/
Metal look	Gold	Pantone 451 C / RAL 1020	/	/	/

In what environment can I use the legend panel ? 1/2

- Indoor usage :
 - 0°C to +50°C
 - Legend panel may become yellowish after 1000h under UV lamp
- Tested at IPx6 , Type 4 : no degradation by the water jets
- Tested on metal & polyester supports :
 - XAPM control station
 - NSYPLM54G polyester enclosure
 - NSYS3D3215 metal control station
 - Stainless Steel support
- Storage :
 - Can be stocked at -40°C to +70°C
 - Installation should be done between +10°C to +40°C
- Instruction sheet is available on SE.com
 - <https://www.schneider-electric.com/en/download/document/MFR43754/>

In what environment can I use the legend panel ? 2/2

- **For all customizable products:**

- IP level limited to IPx6 and IPx7
- Chemical agent's resistance:
- Oils : good resistance
- Cleaning agents: good resistance except alkaline detergents

- **Abrasion resistance:**

- Good resistance to brushes
- Avoid scotch brite use
- Good resistance to water jets (IPx6)

– For any question more detailed from a customer : thanks to send to CCC the detail of the product or cleaning agent and his concentration

- **Legend panels on polyester (plastic) enclosures:**

- We recommend to limit exposure to harsh environments, and if possible indoor use. For outdoor use, risks to quicker ageing if temperature above 50°C and/or high humidity.

Can a legend panel be cut with a laser cutting ?

« Click » to
return to the
summary

- **NO** : the laser is making the ink & the plastic burn => the laser damages the Plastic and the Markings (plastic burrs).
 - Aesthetically not satisfying
 - Impossible to ensure proper mounting with relevant dust & water resistance

- Remark : you can realize some cut out on the edge/corners and inside the legend panel (see slides 27-29)

Customization & limitations

« Click » to return to the summary

	Pushbutton, illuminated pushbutton & pilot light marking		Bezel marking	Bezel color	Control station marking	Label for legend holders	Legend plate plastic	Legend plate metal	
techno	Bi-injection	✓							
	Engraving					✓			
	Numeric printing	✓	✓	Paint	✓	✓	✓		
	Laser		✓					✓	
Color	✓	✓	✓	✓		✓	✓		
IP69/IP69K*	✓		XB4F			✓		✓	
Existing / New	Existing	New	New	New	New	Existing	New	New	New
Customisable		✓	✓	✓	✓		✓	✓	✓
XB4 standard	✓	✓				✓	✓	✓	✓
XB4F flush	✓	✓	Laser			✓	✓	✓	
XB5 standard	✓	✓		✓	✓	✓	✓	✓	✓
XB5F flush	✓	✓	Numeric	✓	✓	✓	✓	✓	

* The product itself is IP69, but the color / marking may disappear if the product is washed repetitively

What is the good size for the definitions of pictures ?

« Click » to
return to the
summary

- The customization tool accept the following formats :
 - JPG
 - BMP
 - PNG
- The file should be between 50 ko & 4 MB
 - The tool accept images lower than 50 ko, but our experience is that the image quality is not satisfying
 - The tool is not accepting images bigger than 4MB

How do I import my logo without a background ?

- By default a JPG is always having a background :
 - if you use a JPG file, you'll get a white rectangle around your logo
- You need to use a PNG with a transparent background
- How to transform a JPG into a PNG file ?
 - Use available image modification software : photoshop, paint.net ...
 - Do it within Powerpoint :
 1. Import your image
 2. In format tab, select the relevant tool : Color > Set transparent color
 3. Put white background as transparent with the above tool
 4. Right click & "Save as picture". Make sure to select PNG file format

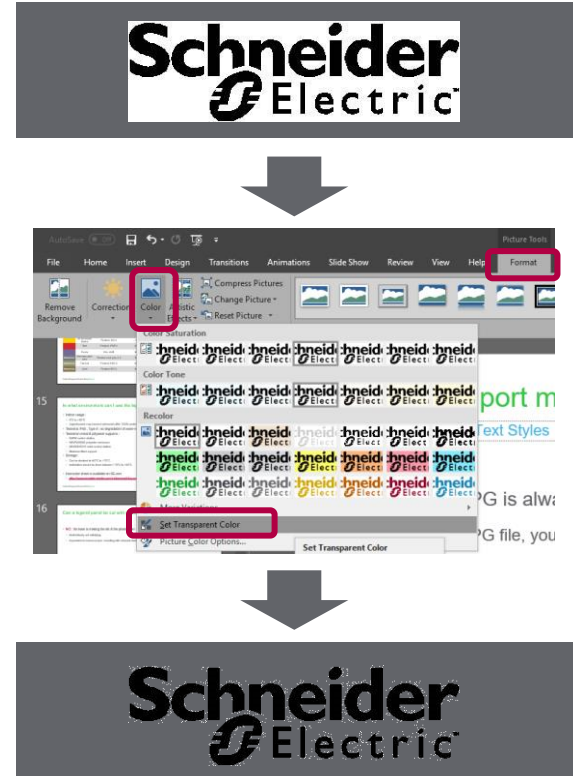

Did you use your own image as logo ? A common mistake is to create a background for your logo on the pushbutton or pilot light

- Bad exemple

Logo



Logo inserted on the customization tool

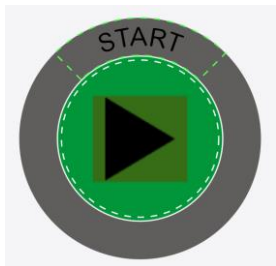

Result



The background appear ...

Did you use your own image as logo ? A common mistake is to create a background for your logo on the pushbutton or pilot light

- Good exemple

Logo



Transparent background

Logo inserted on the customization tool



Result 



! Remark: ONLY *.png file manage transparency

How I can suppress background on my logo or ...

Example with PowerPoint

Select your logo

Select transparent color

Select area for transparency

Your logo background is transparent

Save your picture in ***.PNG**

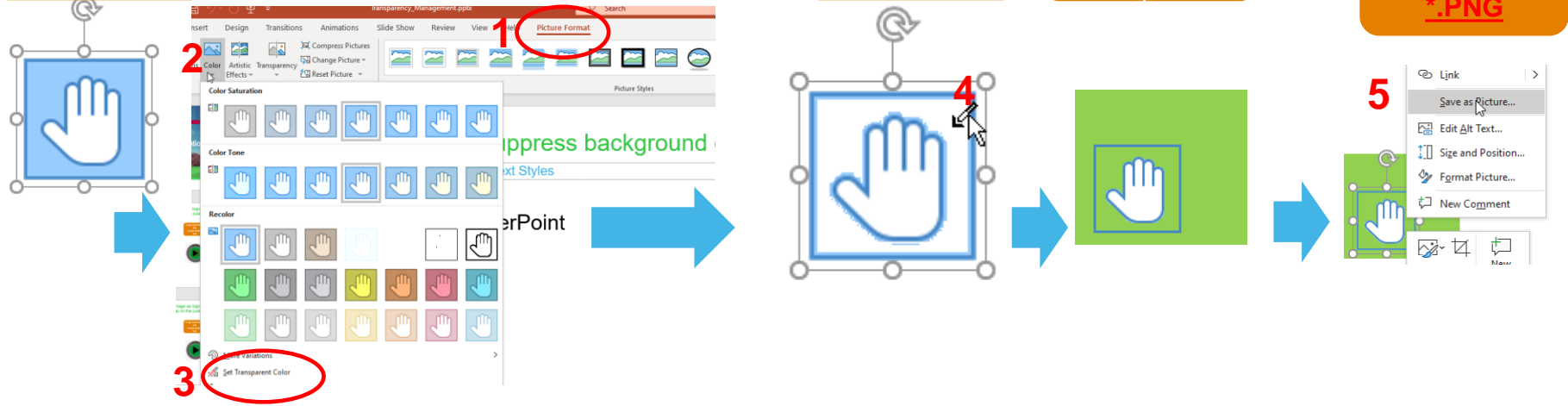

How I can suppress background on my logo or ...

Example with paint.net (More efficient)

- Open a free design tool like [paint.net](#)

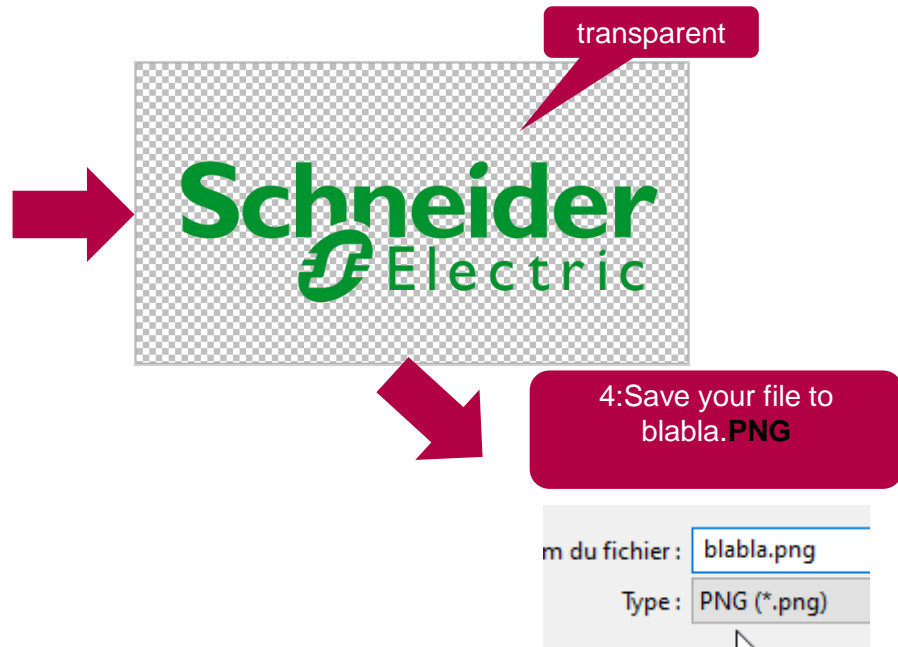
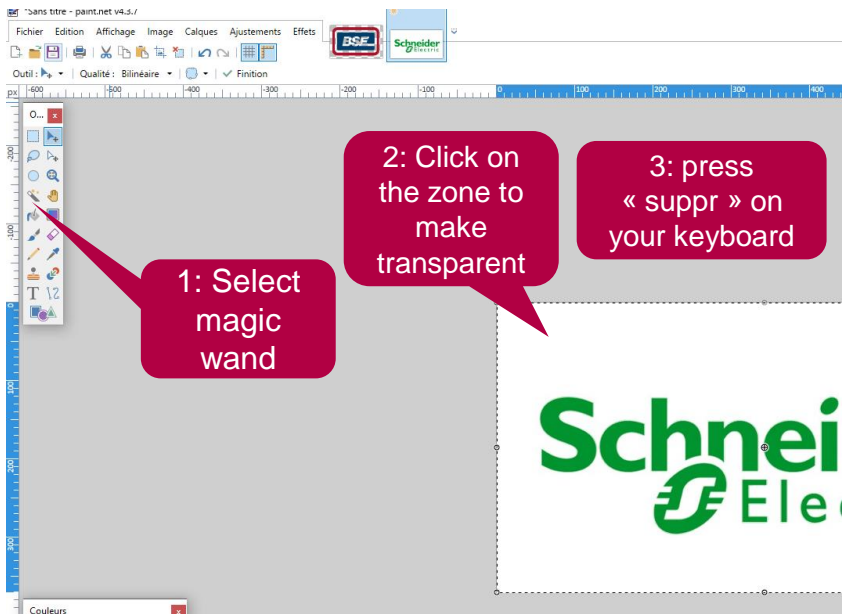

Icons library

« Click » to return to the summary

- Around 4000 available icons :
- By clicking on « Pictogram » and by scrolling on the pictures or by searching your icon by its reference or keyword :

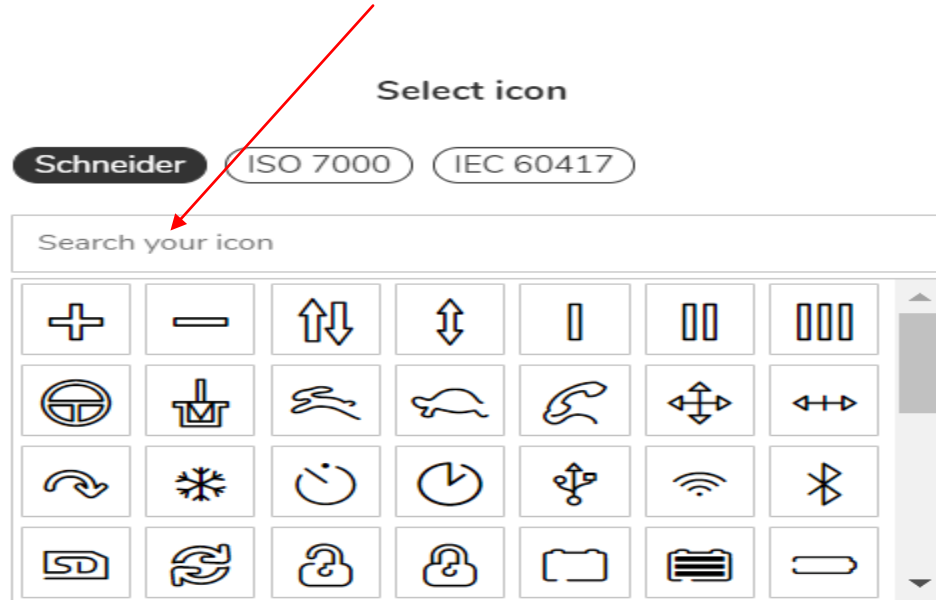
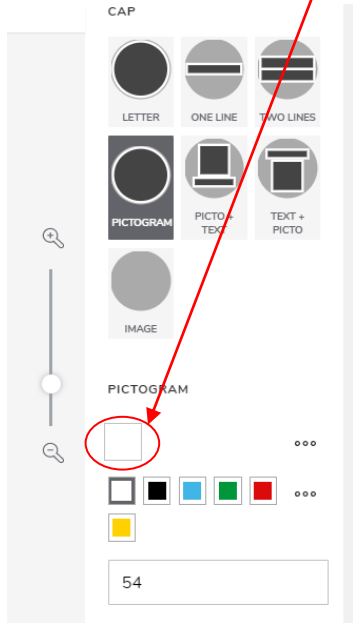

Sources : Schneider, ISO & IEC :

How can I make a personalized cut out? (1/6)

Example with a XAPM1201 box

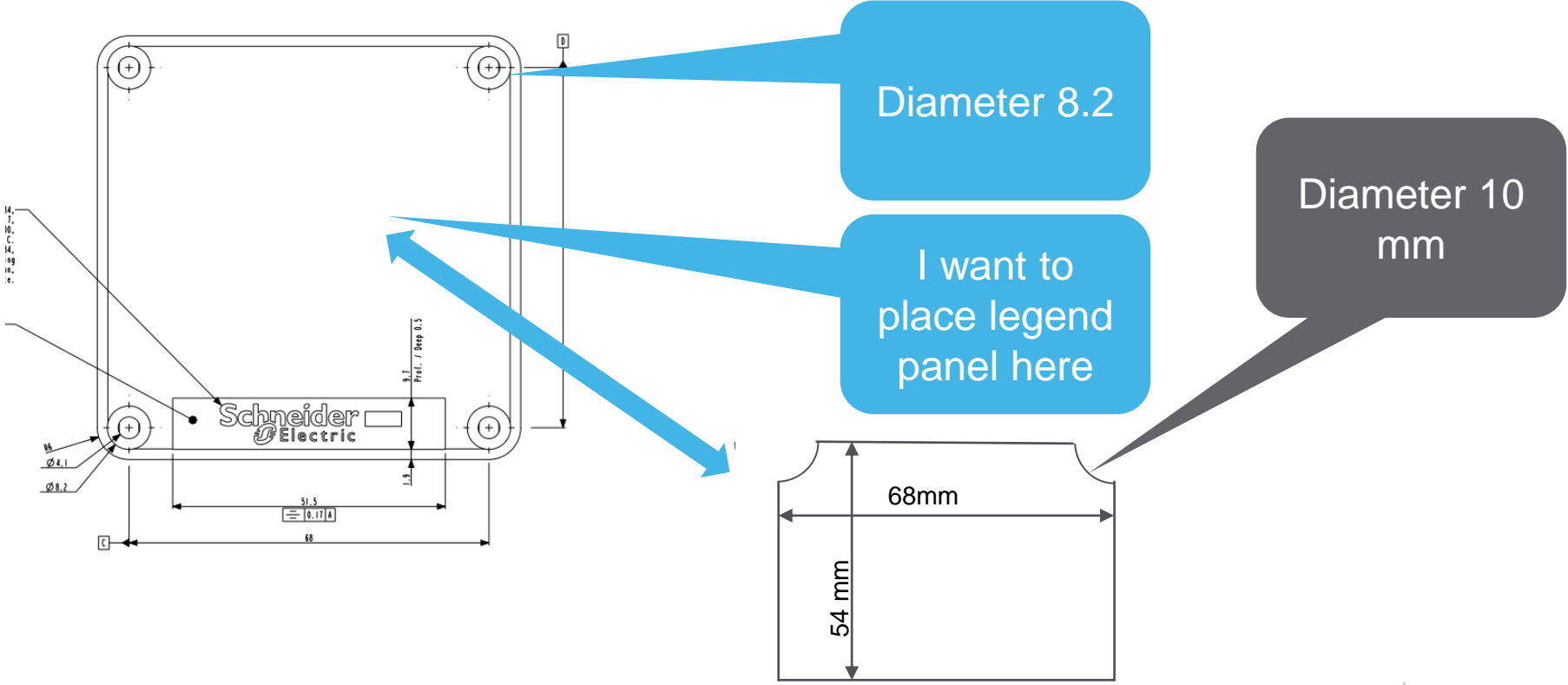

How can I use Figma tool to obtain a customized cut out? (2/6)

« Click » to
return to the
summary

<https://www.figma.com> ▾ Traduire cette page

Figma: the collaborative interface design tool.

With **Figma**, everyone works towards a shared goal. This has enabled our product teams to ship new products faster and feel more confident in their decisions.

Vous avez consulté cette page 2 fois. Dernière visite : 10/01/22

- It's a free tool to make easily *.SVG file for customized cut out for legend panels
- You can create one account, it's free
- No installation needed all is online

How can I use Figma tool to obtain a customized cut out?(3/6)

« Click » to return to the summary

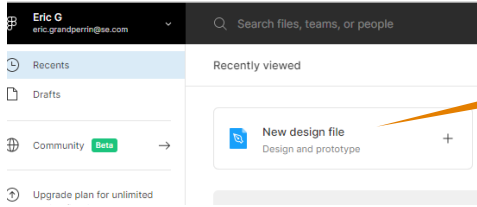

Create a new design

Figma main screen

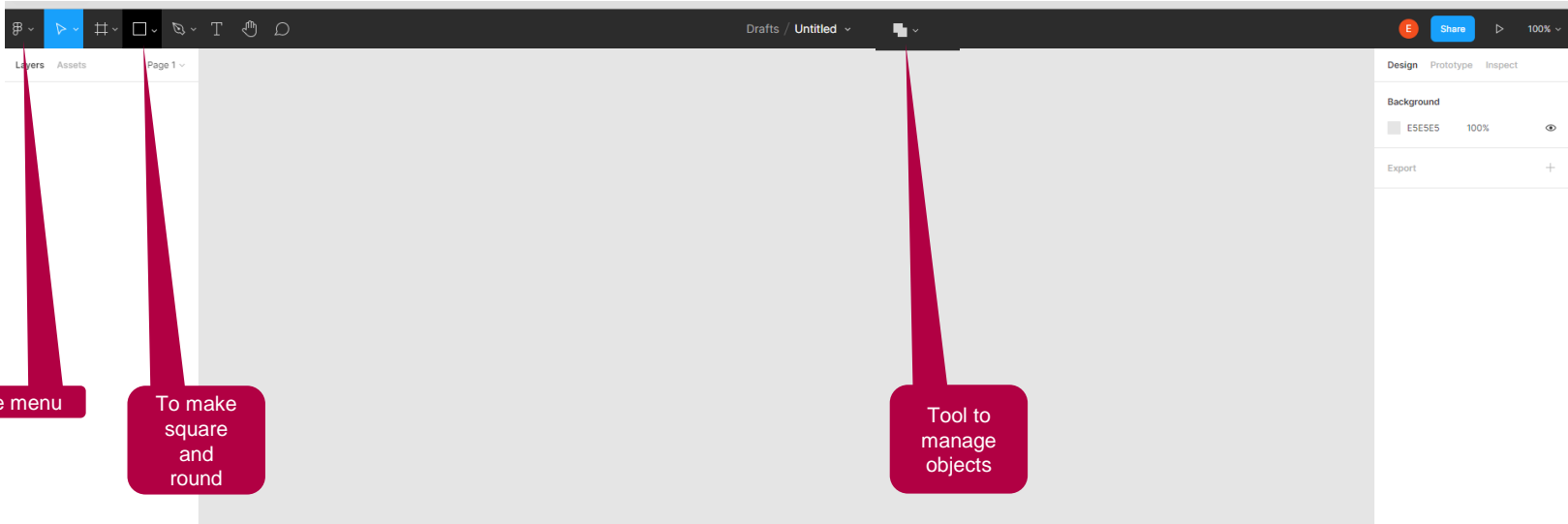

File menu

To make square and round

Tool to manage objects

How can I use Figma tool to obtain a customized cut out? (4/6)

First example for XAP1201 1 pixel = 1 mm

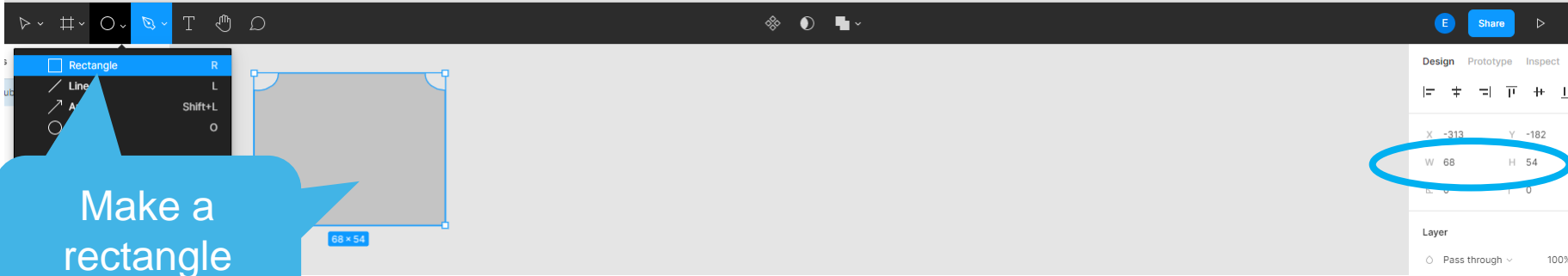

Make a rectangle 68*54

Make a round diameter 10 x 2

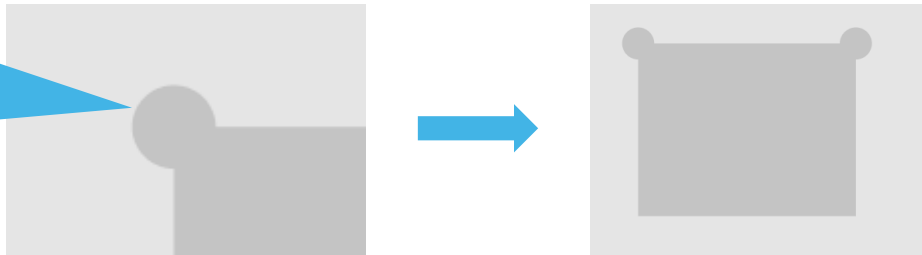

How can I use Figma tool to obtain a customized cut out? (5/6)

« Click » to return to the summary

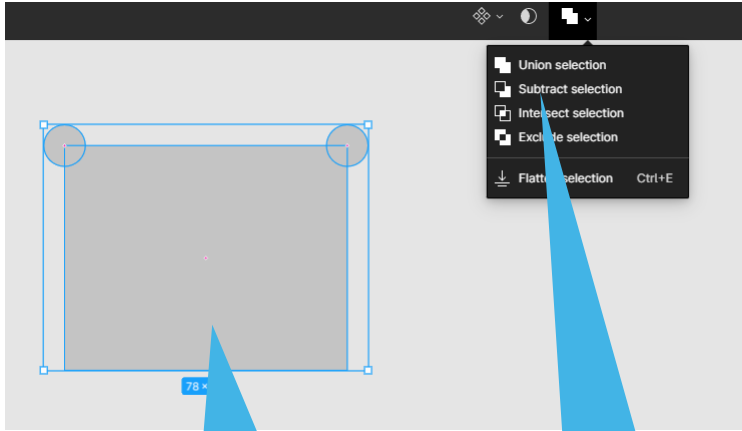

Select all parts

Click on subtract ...

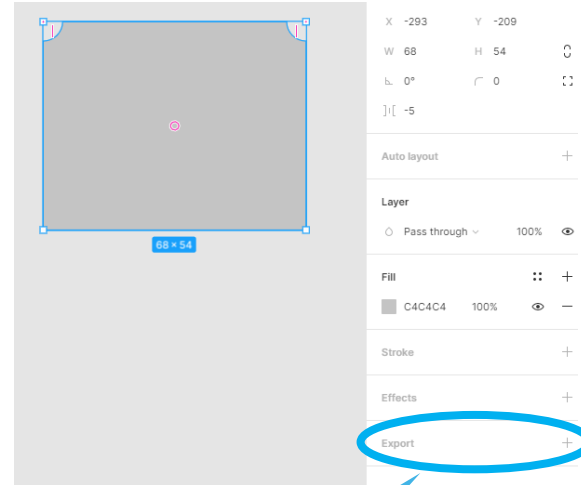

Export *.svg

How can I use Figma tool to obtain a customized cut out? (6/6)

Last step in the Harmony configurator

« Click » to return to the summary

Write the good size
68*54

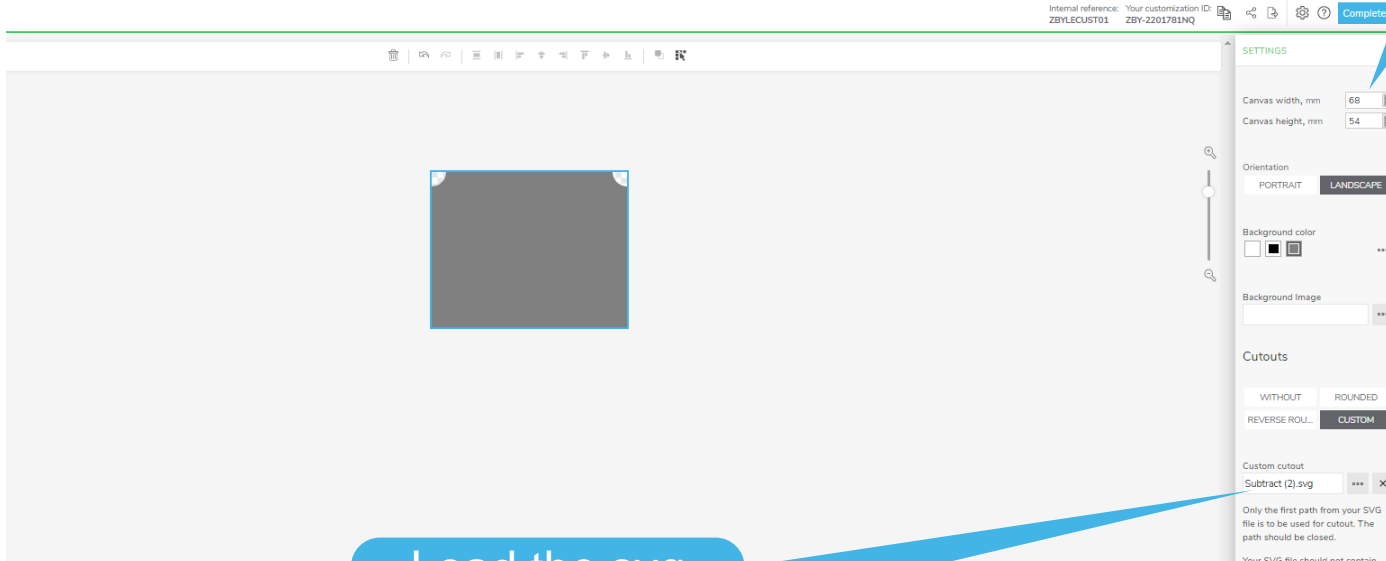

Load the svg file made with figma

What are the possible cut-outs for legend panels ?

- Since June 2020, is it possible to have, internal cutouts :

Scroll down on this page at the bottom left and then choose your internal cut-outs :

Select your legend panel 500 x 100 empty

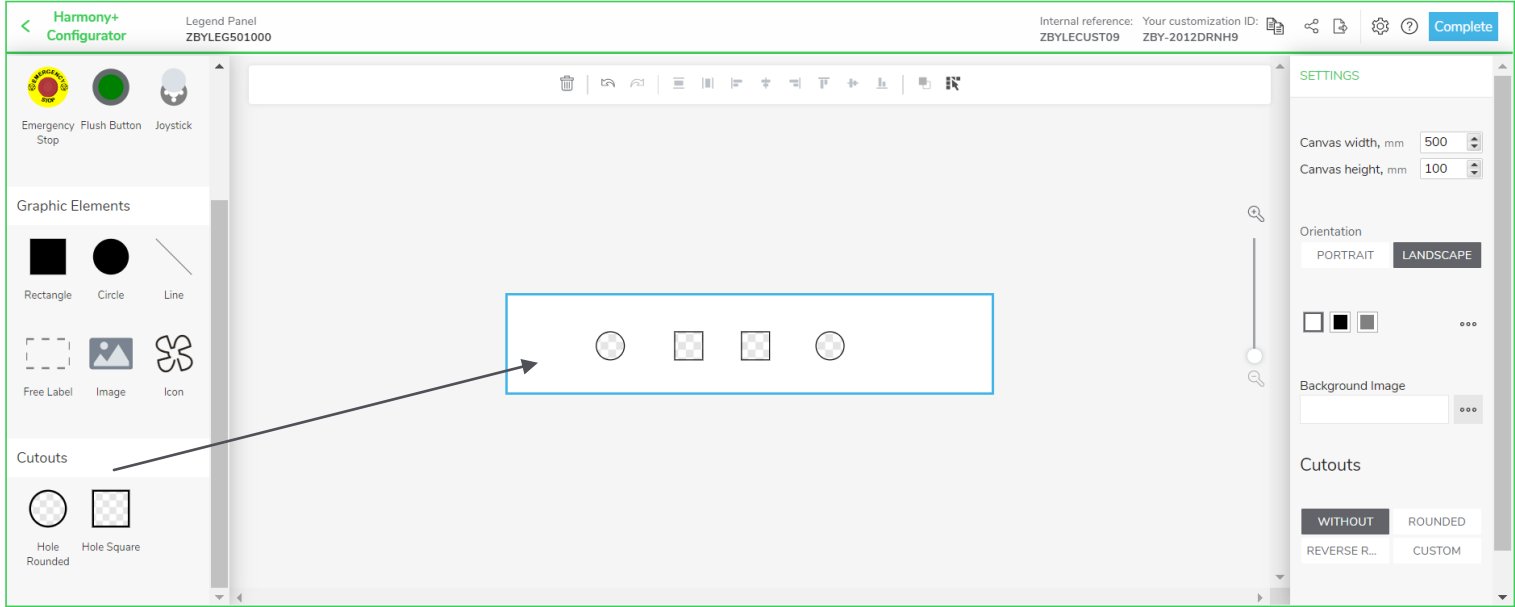

How can I select 2 elements to align them ?

For example to align 2 pushbuttons

- Select the first element
- While pressing the “**Shift**” key, select the second element
- You can then use the top toolbar to align or group the elements

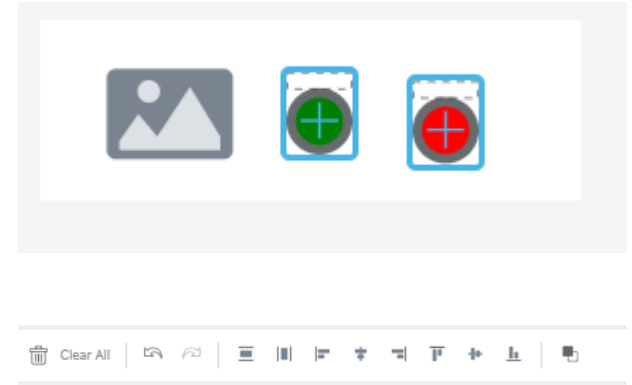

« Click » to
return to the
summary

How do I group 2 buttons to make a motor start/stop panel ?

« Click » to return to the summary

- Create a new legend panel
 - Put your 2 red & green buttons
 - Put your text on top of each button : start & stop
 - Select 1 button, and while pressing “Shift” select the second
 - Use the **icon tool bar** to align them
 - Use the **icon tool bar** to group them
 - Choose a **background** for the group
 - Add a Text **label** to the group : Motor
 - Add “space” to the right to move the text to the left
 - Increase background margins as needed to control your shape
 - Finish your legend panel & order it
-
- Warnings :
 - if you ungroup the buttons, you’ll loose the group background & label
 - Once grouped, you need to ungroup the buttons to change the distance between them : make sure you place them correctly before grouping them

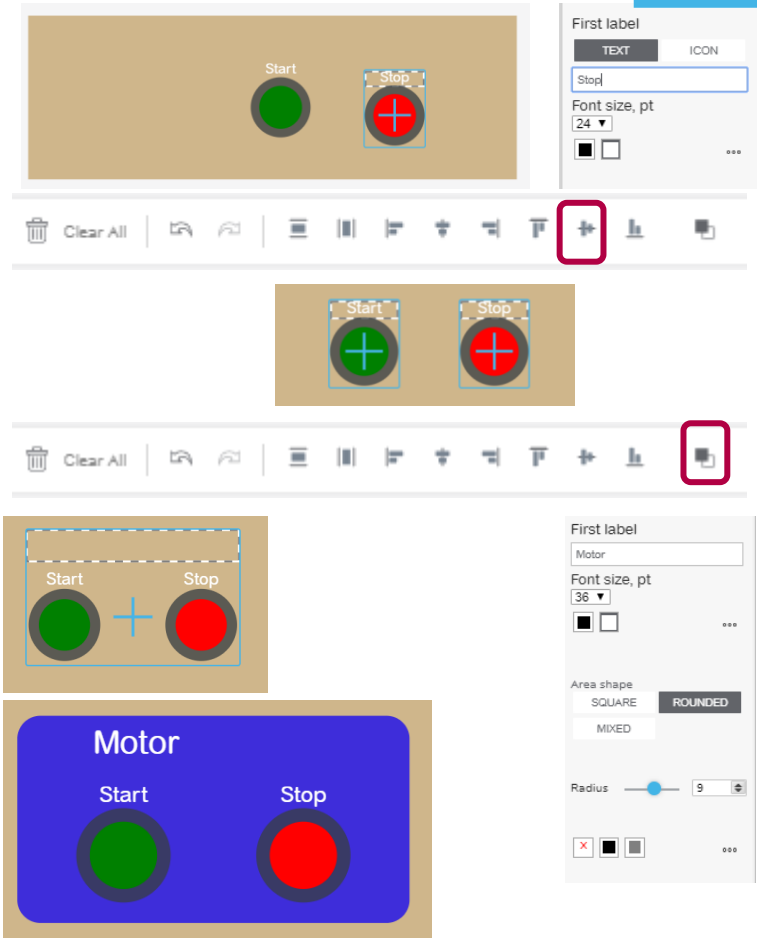

Control station : my text is not in the good direction

- When using a XALD in portrait mode, the text are turned 90° because the pushbutton orientation is fixed
 - i.e. bottom of the text = right of the control station
- Current workaround :
 - Create your text in Powerpoint
 - Put it in the good color and center it both in width & height
 - Rotate left by 90°
 - Right click, “save as a picture” & save it as a PNG file
 - Import the image in the customization tool

Start



Why can't I save my legend panel due to conflict between elements ?

« Click » to
return to the
summary

- The conflict is there to prevent a text to be hidden, 2 holes to be merged together or 1 hole to be on top of a text
- Each component is coming with a background area. 2 background areas can't be overlapped or you won't be able to complete the customization
- An element partially or totally outside the legend panel is also a conflict
- Exceptions : the following elements are conflicting only with the external border of the legend panel, not with other elements :
 - Free shapes (rectangles, circles & lines)
 - Images
 - Logos

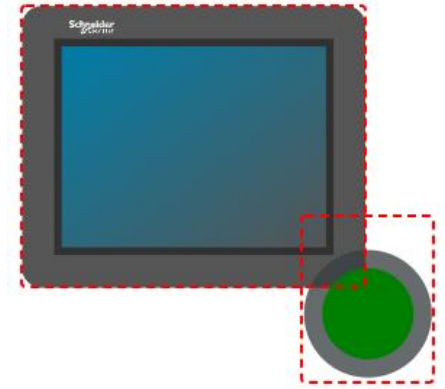

Example : an HMI & a pushbutton are in conflict

My elements are not superposed properly...

« Click » to
return to the
summary

- The latest created element is always on top
 - In the example : the red square
- You need to copy-paste (Ctrl+C , Ctrl+V) the oldest element, then delete the old version and move back the new element at the good place

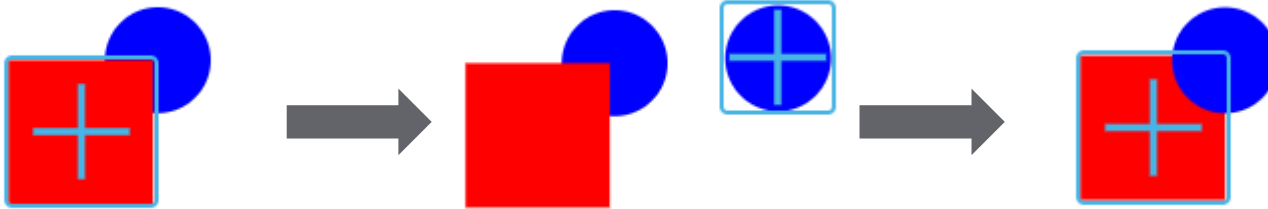

- Impacted elements :
 - Free shapes (rectangles, circles & lines), Images, Logos
- Not impacted elements :
 - Pushbuttons, HMI, Free labels ...

I want to do a hatched round rectangle

« Click » to return to the summary

- There is no such shape in the tool
 - You can create it externally (Powerpoint, Photoshop, Paint.net ...) and import it as an image
 - To create in Powerpoint :
 - Use shape with the “good” dimensions
 - Use 2 round rectangles and a lot of parallelograms
 - Use the “marge Shapes” > “fragment” function in the “Format” tab
 - Put colors, group and “Save as a picture” (right-click) Don’t forget to use PNG format to not have a background
- You can try to do it in the tool with hatched circles and rectangles, but mostly the hatches don’t align correctly
 - Example : **ZBY-19083NEY8**

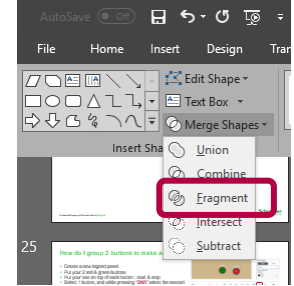

Last news customization : other functions improvements 1/2

« Click » to return to the summary

Select your Harmony XB5

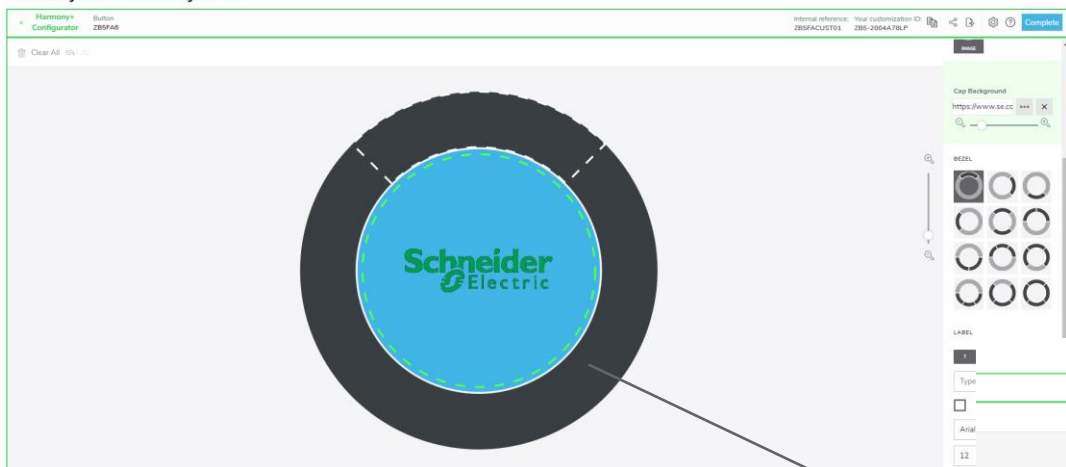

✓ Move the image on the cap of the pushbutton :
press CTRL , and move the image with your mouse

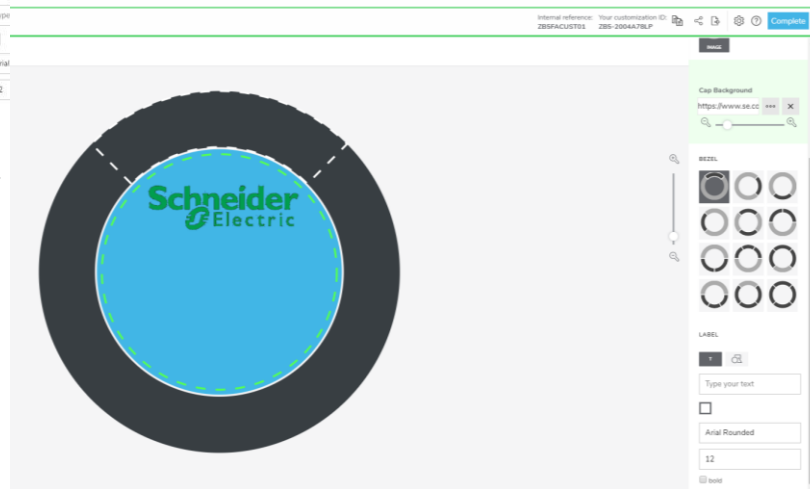

Last news customization : other functions improvements 2/2

« Click » to return to the summary

Select your Harmony XB5



✓ New policies font included in the tool : Verdana added to Arial Rounded

Possibility to include others Alphabet (by copy paste of text) :
- Chinese , Japanese , Cyrillic , Arabic are now working

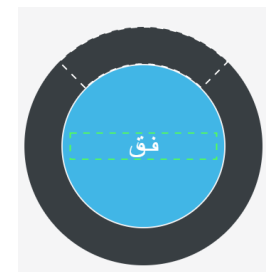

I can't finish my drawing! An object is present and you want to erase it :

« Click » to return to the summary

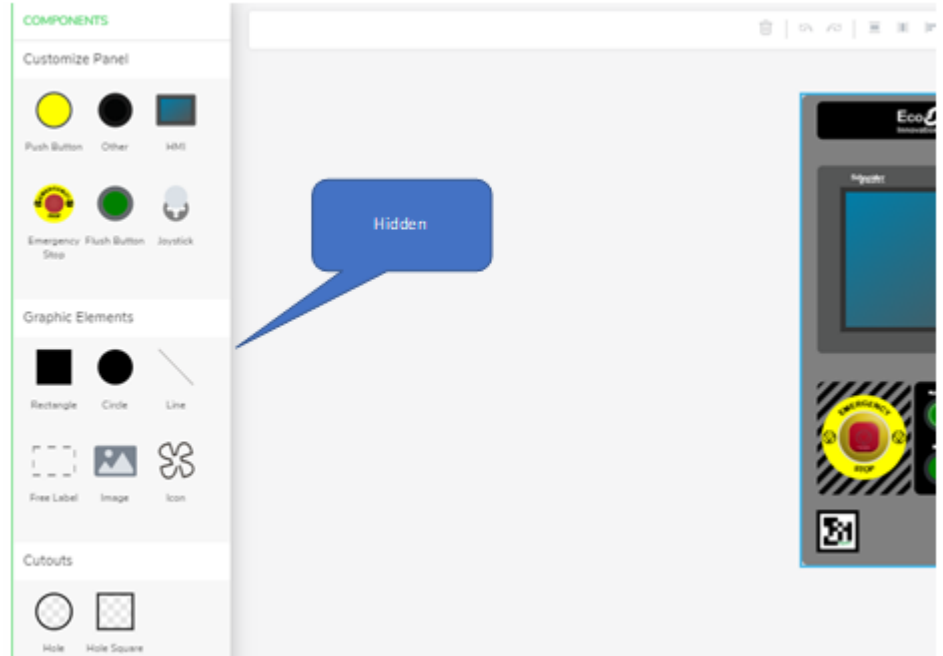
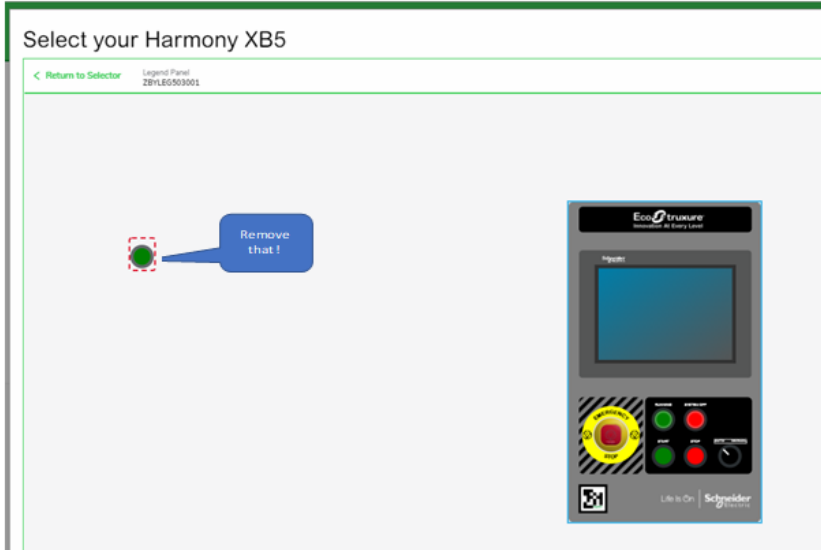

But its hidden due to the view :

Change your screen zoom by (CTRL + scroll up) and remove the green button :

« Click » to return to the summary

Select your Harmony XB5

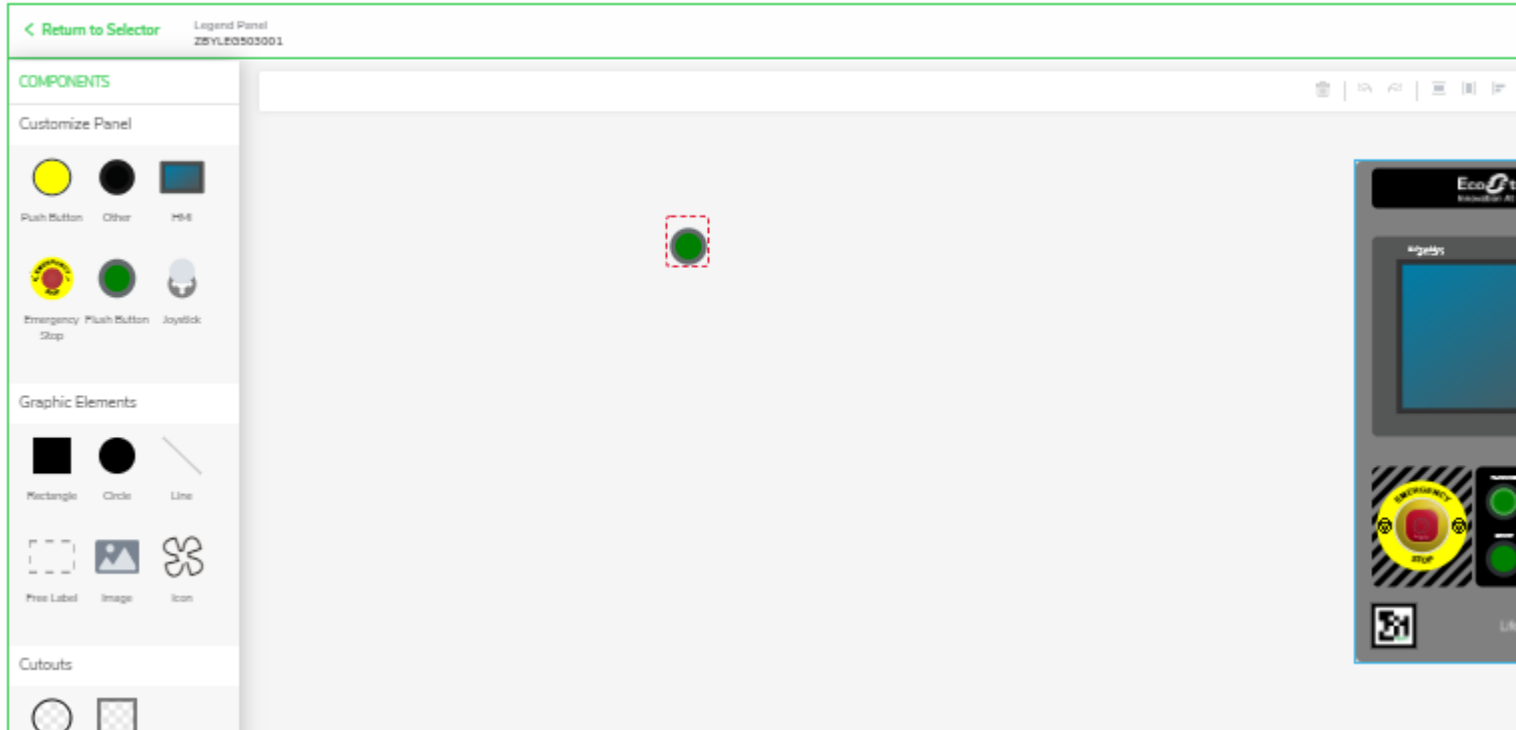

Images on pilots lights diameter 22 : we recommend to avoid use of images with solid color uniform :

Pilot light diameter 22 present a curve surface , and due to our ink printing technology , this gives not optimal results with images presenting large uniform color : see example hereunder with a complete dark unique color



Remark : this is not the case with the other products , who present planned front faces (like flush pilot lights , or illuminated pushbuttons)

Can I use the legend panel to get a multi-language e-stop marking ?

« Click » to
return to the
summary

- Yes, just refer to the attachment for details
- However, depending on the local price list, some customers may find this to be expensive

How to use

- 1 – Select the template page according to existing reference
- 2 – Modify text
- 3 – Zoom the final picture to copy screen in the maximum quality
- 4 – Open customized template, duplicate
- 5 – Replace background Image by import of new saved picture
- 6 – Verify customization by technical preview

« Click » to
return to the
summary

Template ZBY8L***

Used for illuminated Emergency Stop

Label Ø 90mm

Customized template : **ZBY-1905DRV78**

Could be used for :

E-Stop Reference ZB5AS84W**

Note : label will be without cut-out for holes



« Click » to
return to the
summary



CustomizationID: ZBY-1906EZA0B

1 text (Arial 32)

For E-Stop Reference ZB5AS84W**

« Click » to
return to the
summary



CustomizationID: ZBY-1906EZAD6

2 text (Arial 28)

For E-Stop Reference ZB5AS84W**

« Click » to
return to the
summary



Template ZBY8***

Used for standard Emergency Stop

Label Ø 90mm

Customized template : **ZBY-1906EXU1Y**

Could be used with E-Stop Reference :

ZB5AS844

ZB4BS844

Note : label will be without cut-out for holes



« Click » to return to the summary

ZBY-1906EXU1Y template for 90mm size

1 text (Arial 32)

« Click » to
return to the
summary



ZBY-1906EZA WG template for 90mm size

2 text (Arial 28)

For E-Stop ZB5AS844

For E-Stop ZB4BS844



« Click » to
return to the
summary

Template ZBY9***

Used for standard Emergency Stop

Label Ø 60mm

Customized template : **ZBY-1906EY23M**

Could be used with E-Stop Reference :

ZB5AS844

ZB4BS844

Note : label will be without cut-out for holes,
stick the label and make the hole



« Click » to
return to the
summary

ZBY-1906EY23M template for 60mm size

2 text (Arial 28)

« Click » to return to the summary



« HOW TO USE »

More information with picture and detail information

« Click » to return to the summary

Step 3 : copy screen

1 - Zoom at the maximum size and copy screen picture corner to corner

1

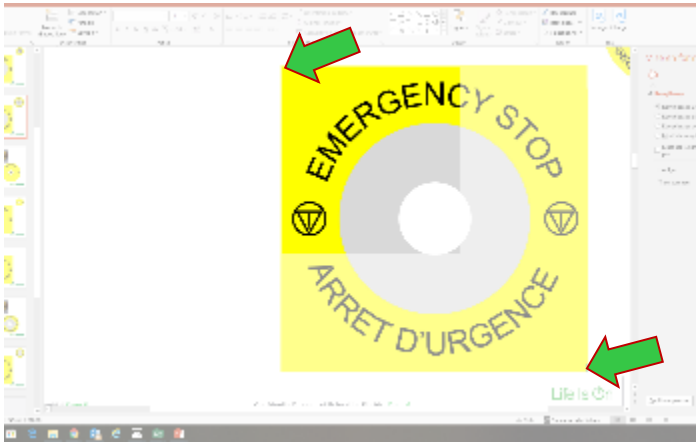

2 – Save your picture

2

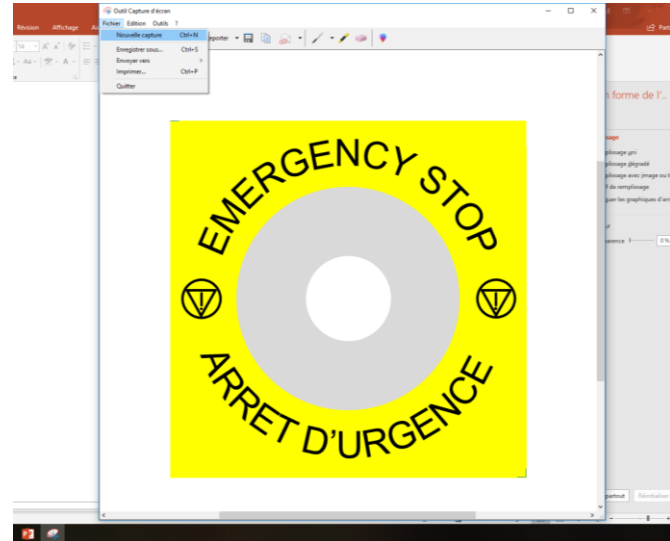

Step 4 : open customized template

« Click » to return to the summary

1

1 – Go to se.com
Select Harmony range or clic on
this link

<https://www.schneider-electric.com/en/product-range/632-harmony-xb4/?filter=business-1-industrial-automation-and-control>

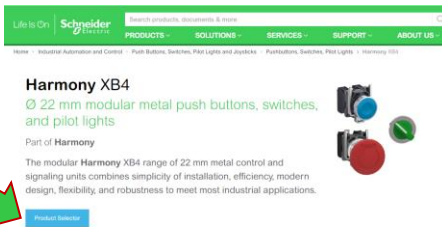

2

2 – open **PRODUCT SELECTOR**



3

3 – add customized template ID and
clic OK

Select your Harmony XB4

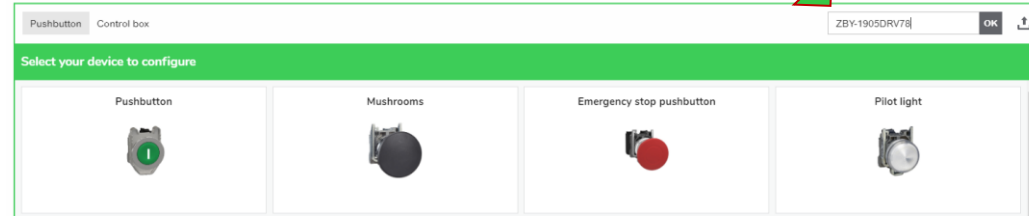

4

4 – Clic on « Duplicate »

Select your Harmony XB4

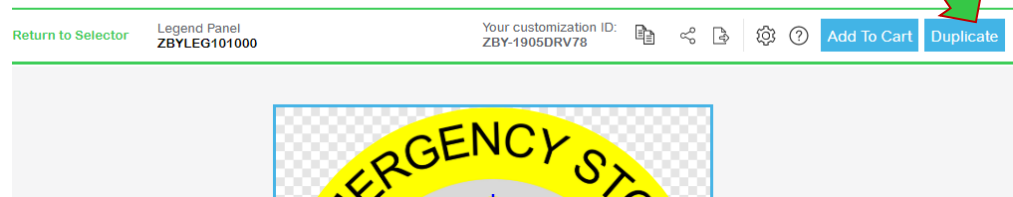

Step 5 : replace background image

« Click » to return to the summary

Select your Harmony XB4



Click to import new background image

Step 6 : Verify your customization

1 - Clic to open

Select your Harmony XB4

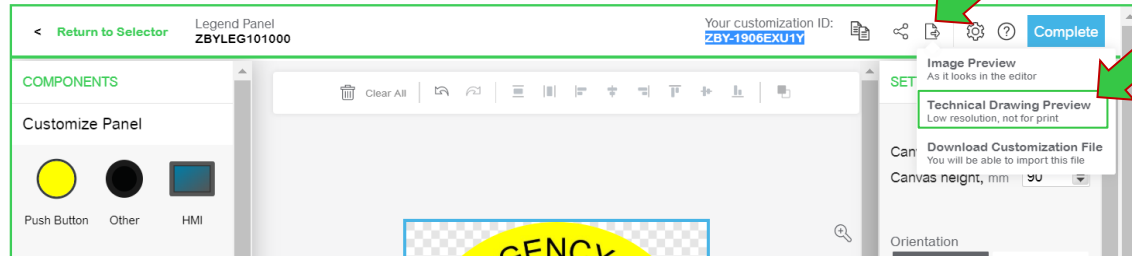

2 - Clic « Technical Drawing Preview » to download picture

3 - Open picture and verify your customization



Life Is On | **Schneider**
Electric