

HORIZONTAL BOLT-ON TAP OFF INSTALLATION INSTRUCTIONS FOR I-LINE® II AND I-LINE PLUG-IN BUSWAY

⚠ DANGER

HAZARD OF ELECTRIC SHOCK, BURN, OR EXPLOSION. RISQUE D'ÉLECTROCUTION, DE BRÛLURES, OU D'EXPLOSION

- Turn OFF power to busway before installing/removing, or working on this equipment.
- Install only 3-pole device on 3-pole busway. Install only 4-pole device on 4-pole busway. Install device onto busway with "G" suffix in catalog number only.
- Using continuity tester or 500 volts maximum meg ohm meter, perform continuity test to ensure phase-to-phase and phase-to-neutral and ground isolation.
- Replace all parts and close cover before turning power ON.
- Mettre la barre blindée hors tension avant d'installer/ôter ou de travailler sur cet équipement.
- Installer uniquement un dispositif à 3 pôles sur une barre blindée à 3 pôles. Installer uniquement un dispositif à 4 pôles sur une barre blindée à 4 pôles. Installer uniquement un dispositif sur une barre blindée avec le suffixe «G» du numéro de référence du catalogue.
- En utilisant un testeur de continuité ou un compteur de mégaohms de 500 volts maximum, procéder à l'essai de continuité pour assurer la phase à phase, la phase à neutre et l'isolation de terre.
- Remplacer toutes les pièces et fermer le couvercle avant de remettre la tension.

Failure to follow these instructions will result in electric shock, severe personal injury, or death! L'observation des instructions ci-dessus entraîne une électrocution, des blessures graves, voire la mort.

Follow all steps in order. Refer to DANGER section above before starting. Turn OFF power to busway before installing or removing plug, or working on line side of switch.

1. Fig 1: Remove insulator and busway door per label 45123-625-01.

Note: Some busway have insulators and covers that are not removable. Swing insulators and covers open; secure open with electrical tape. (Shown with insulators/covers removed.) (1)

2. Figs 1, 2: Unfasten nuts (2).

3. Figs 1, 2: Remove U-clamps (3).

4. Fig 1: Position tab (4) into slot (5) of busway.

5. Figs 1, 2: Place U-clamps (3) onto bolts (6).

Fig 2: Ensure notch in U-clamps (3) goes in flange on busway, as shown.

6. Figs 1, 2: Thread nuts (2) onto bolts (6) and tighten to 125–150 lb-in (14–17 N•m).

7. Figs 1, 2: Position threaded rods (7) into the outside slots of the hanger. (The installer provides the rods and secures them to the superstructure.)

8. Figs 1, 2: Place washers (8) and thread nuts (9) to threaded rod (ensure the hanger shelf is 90° with face of busway and is level from end to end). Installer provides washers and nuts.

9. Fig 8: Ensure that 1/2" connector bolt (20) is as loose as cotter pin allows, then tighten one full turn.

Fig 6: If unit will be installed in opening next to a joint, remove one scalloped barrier (21) nearest busway joint; reinstall, using the round holes.

Note: Barrier will be reinstalled with scalloped side away from busway as it was shipped. Only the hole location is different. If unit will be installed at any opening other than next to a joint, leave barriers as shipped. If unit will be installed at any opening other than a joint and will be installed on I-LINE corrugated busway, install both barriers with scalloped side toward busway, using the oblong holes.

10. Figs 1, 3, 10: Remove nuts (13) and U-clamps (12) from hex head bolts (11). Place unit on hanger system.

11. Figs 1, 3, 10: Place U-clamps (12) on busway and on each side of plug-in unit. Thread bolts (11) through slot in brackets (19) and through hole in U-clamps (12).

12. Fig 3: Thread nuts (13) to bolts (11). Tighten one full thread.

13. Fig 6: Center throat (14) to busway. Measure bottom throat and bottom of busway. The distance should be 1/8" (3 mm).

Figs 3, 7: To adjust unit up or down, unthread bolts (15) one turn; adjust with bolts (16) and nuts (9). Then tighten bolts (15).

14. Fig 5: Align plug-in unit side to side. While facing unit, position unit so that straight edge of alignment arrow (17) is at left edge of slot (18).

15. Figs 3, 4, 8: Tighten each nut (13) alternately 1/2" (12.7 mm) until the connector bolt (20) touches the busway.

Figs 3, 5: Tighten each nut (13) until washers (22) are in line with the frame. The unit is now plugged in.

16. Fig 8: Tighten connector bolt (20) until outer head breaks off.

17. Using continuity tester or 500 volts maximum meg ohm meter, perform continuity test to ensure phase-to-phase, and phase-to-neutral and ground isolation.

18. Fig 9: If the gutter space is desired at the bottom, read note.

19. If unit is removed from busway for any reason, always perform the following steps.

- Turn OFF busway power first.
- Loosen connector bolt before removing unit.
- Reinstall the insulator and door into the busway opening.
- If unit will be relocated, use a torque wrench to tighten connector bolt from 60 lb-ft (81 N•m) to 80 lb-ft (108 N•m).

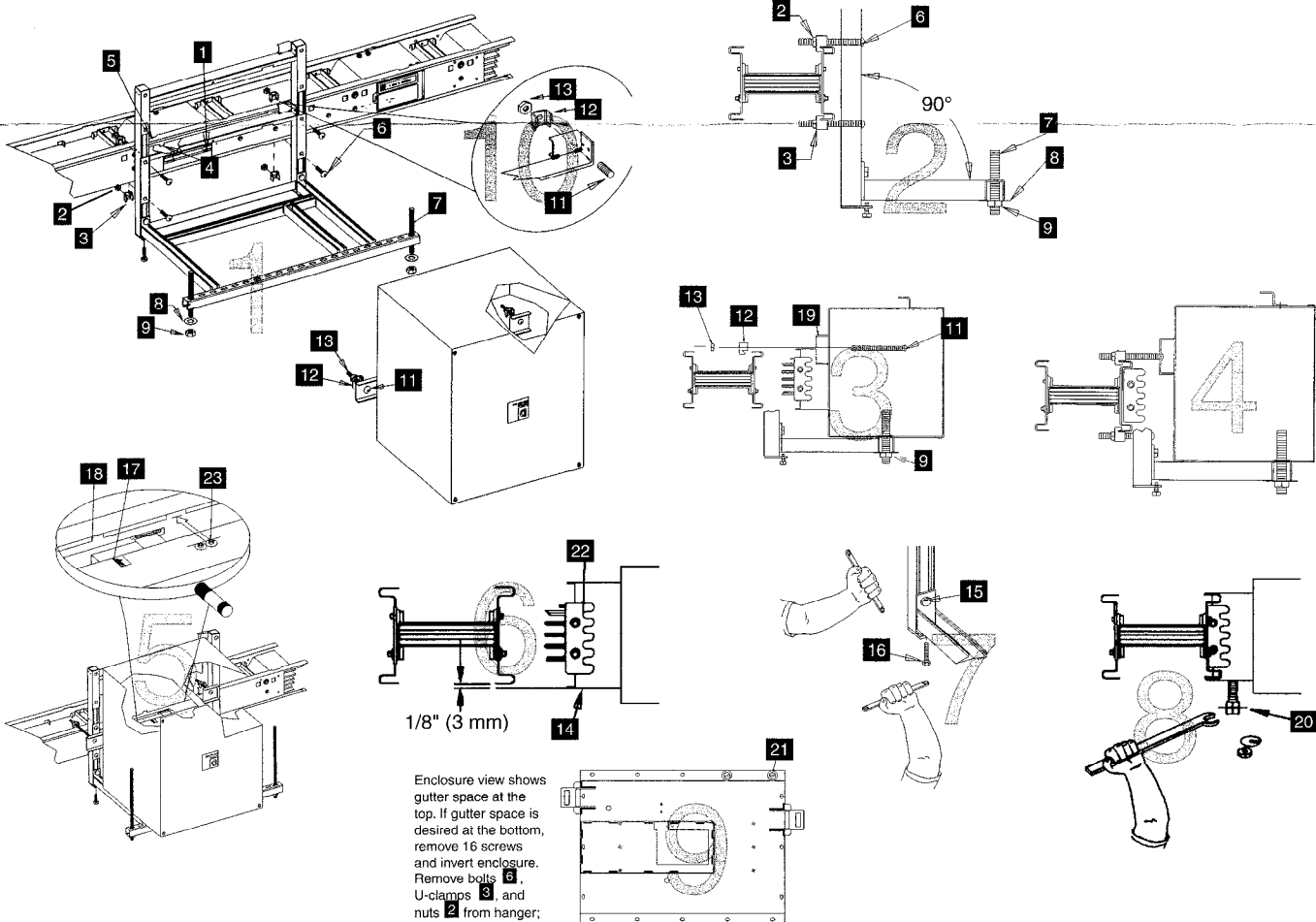

Enclosure view shows gutter space at the top. If gutter space is desired at the bottom, remove 16 screws and invert enclosure. Remove bolts 2, U-clamps 3, and nuts 2 from hanger; place in top set of holes (fig. 1). Hang bracket as described in steps 1–17.