

Instruction Bulletin

Replaces 63230-216-223A3

POWERLOGIC[®] Sub Meter Display (SMD and SMDOPN)

ENGLISH

Retain for future use.

CONTENTS

CONTENTS	1
INTRODUCTION	2
Parts of the Sub Meter Display	3
INSTALLATION	4
Mounting the SMD	4
Mounting the SMDOPN	4
COMMUNICATIONS	6
Downstream Devices	7
Upstream Devices	7
Terminating the Last Device in the Downstream Daisy Chain	8
POWER CONNECTION	9
SETUP	9
Entering the Password	9
Initializing a System	10
Viewing the Setup Mode Submenus	10
Monitoring Mode	12
Viewing and Resetting Alarms	12
TROUBLESHOOTING AND MAINTENANCE	13
Changing the Battery	13
Changing the Fuse	13
QUICK REFERENCE MENU TREE	14
SPECIFICATIONS	15
MOUNTING TEMPLATE	16

INTRODUCTION

The POWERLOGIC Sub Meter Display (SMD and SMDOPN) is a comprehensive electrical sub metering display (Figure 1). With the display, you can view electrical parameters with one networked LCD. In addition to viewing system data on the display itself, you can also view data on a remote PC via a network connection. Touch pad buttons provide a convenient way to view downstream devices on the power monitoring network. The display is RS-485 Modbus RTU compatible. It has additional RS-485 and RS-232 Modbus ports for networking to additional displays or to a master PC.

Figure 1: The Sub Meter Display

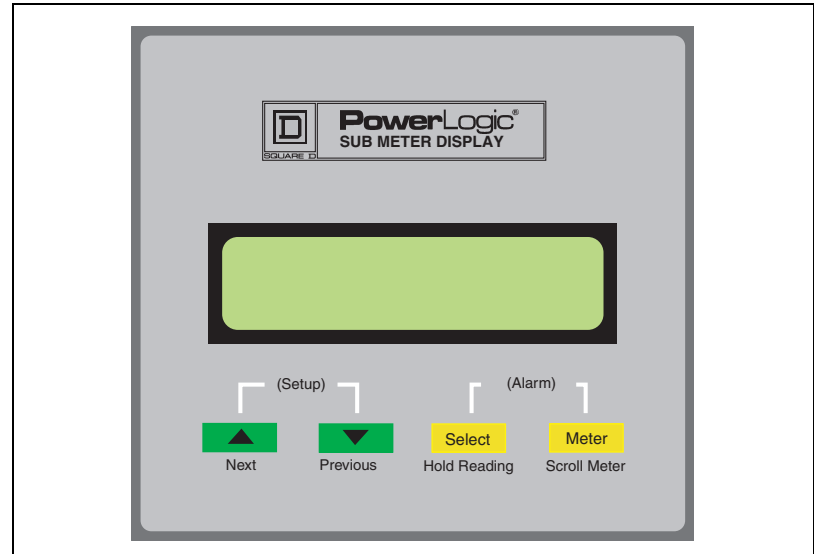

The display provides local indication of all power system parameters from the compatible meters connected downstream. All system parameters and alarms can transmit to the network operations center by means of Modbus RTU protocol. If the network operations center is not yet established, you can upload data to a Palm OS[®] device via the infrared communications port located on the front of the display.

The display supports the following multiple sensors:

- ENERCEPT[®] Meters
- Branch Circuit Monitors (BCM42 and BCMSC)
- Multi-Circuit Meters (MCM8364)
- Alta Labs Network Temperatures and Humidity Sensors (HXO-485, TXO-485, and HXO/T-485)

Parts of the Sub Meter Display

Figure 2 shows the parts of the display, while Table 1 describes these parts.

Figure 2: Parts of the Display

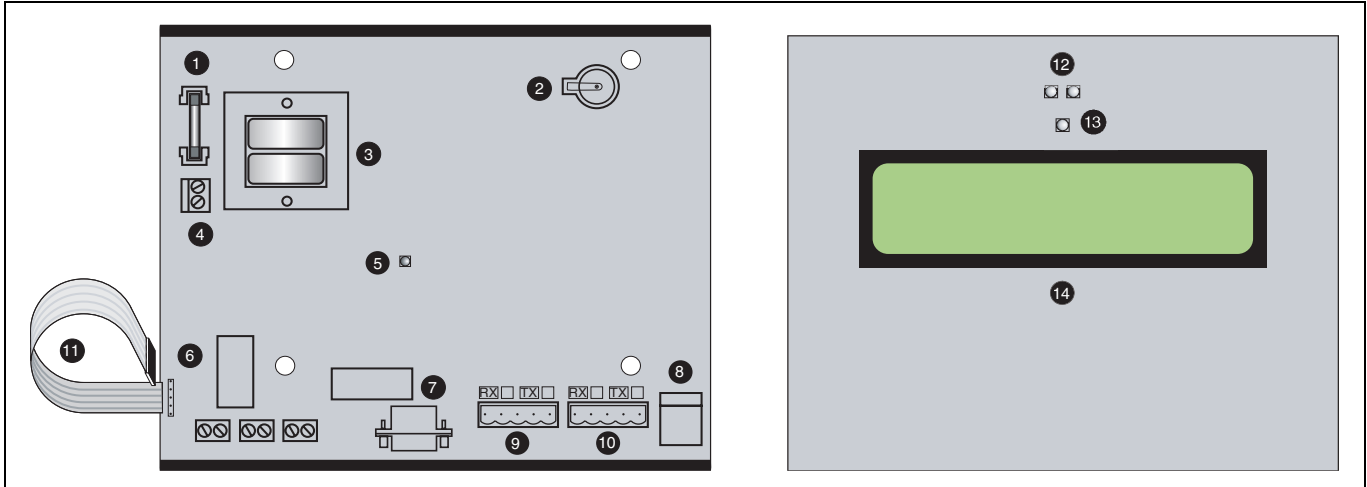

Table 1: Parts Description of the Display

Part	Description
1	250 Vac 200 mA fast fuse Fused power connection for circuit protection.
2	Lithium battery Onboard clock backup.
3	Power transformer Linear power supply for reliability and low noise.
4	120 Vac power supply terminals 2-wire, 120 Vac, 60 Hz, line to neutral.
5	Auxiliary input status LED Indicates alarm condition for the auxiliary input.
6	Membrane switch pin connector Connection point for push button panel.
7	Upstream RS-232 input jack Connection point for upstream RS-232 network.
8	12 Vdc power port Alternate 12 Vdc connection point for use with plug-in wall-mount transformer or power supply. (Auxiliary input is disabled if 12 Vdc power is used.)
9	Upstream RS-485 connection point Terminal for upstream RS-485 network. 2- or 4-wire compatible.
10	Downstream RS-485 connection point Terminal for downstream RS-485 network. 2- or 4-wire compatible.
11	Membrane switch ribbon cable (From customer-supplied face plate)
12	Infrared port Palm OS device communications port. This port is disabled if the upstream RS-485 connection point is used.
13	Status LED Green = Normal Operation. No network devices are in warning or critical alarm mode. Yellow = One or more network devices are in warning alarm mode. Red = One or more network devices are in critical alarm mode or the auxiliary input is active.
14	Liquid crystal display High-resolution LCD with adjustable backlight.

ENGLISH

INSTALLATION

⚠ DANGER

HAZARD OF ELECTRIC SHOCK, EXPLOSION, OR ARC FLASH

- Apply appropriate personal protective equipment (PPE) and follow safe electrical work practices. See NFPA 70E.
- This equipment must be installed and serviced only by qualified personnel.
- Turn off all power supplying this equipment and the equipment it is to be mounted inside before working on or inside equipment.
- Always use a properly rated voltage sensing device to confirm that power is off.
- Replace all device doors and covers before turning on power to this equipment.

Failure to observe these instructions will result in death or serious injury.

Mounting the SMD

The SMD ships pre assembled in a UL508 listed equipment enclosure. The enclosure is equipped with knockouts for power and communication conduit attachments and requires no field assembly except for enclosure mounting.

Mounting the SMDOPN

The SMDOPN is an open board product that requires field mounting in an enclosure or panel. To mount the display in a panel enclosure, refer to Figure 3 and Figure 4 on page 5 and follow these steps:

1. Ensure that the display is not connected to power and turn off all power supplying the equipment it is to be mounted inside before working on or inside the equipment.
2. Use a properly rated voltage sensing device to confirm that power is off.
3. Using the template provided with your SMDOPN as a guide, drill holes and cut openings in the panel or enclosure.
4. Thread the membrane switch ribbon cable (A) through the rectangular opening.
5. Mount the display faceplate (B) onto the panel.

Figure 3: Mounting the Display in a panel

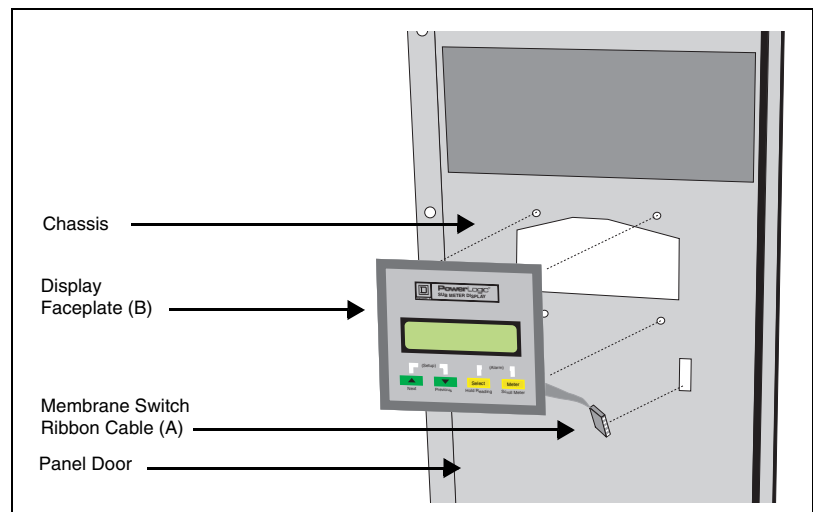

6. Secure the faceplate by screwing four threaded stand-offs (C) into the faceplate studs from the inside of the door.
7. Attach the display (D) to the threaded studs using the four #6-32 screws (E) provided.
8. Connect the membrane switch ribbon cable (A) to the membrane switch pin connector (F).

Figure 4: Display Components

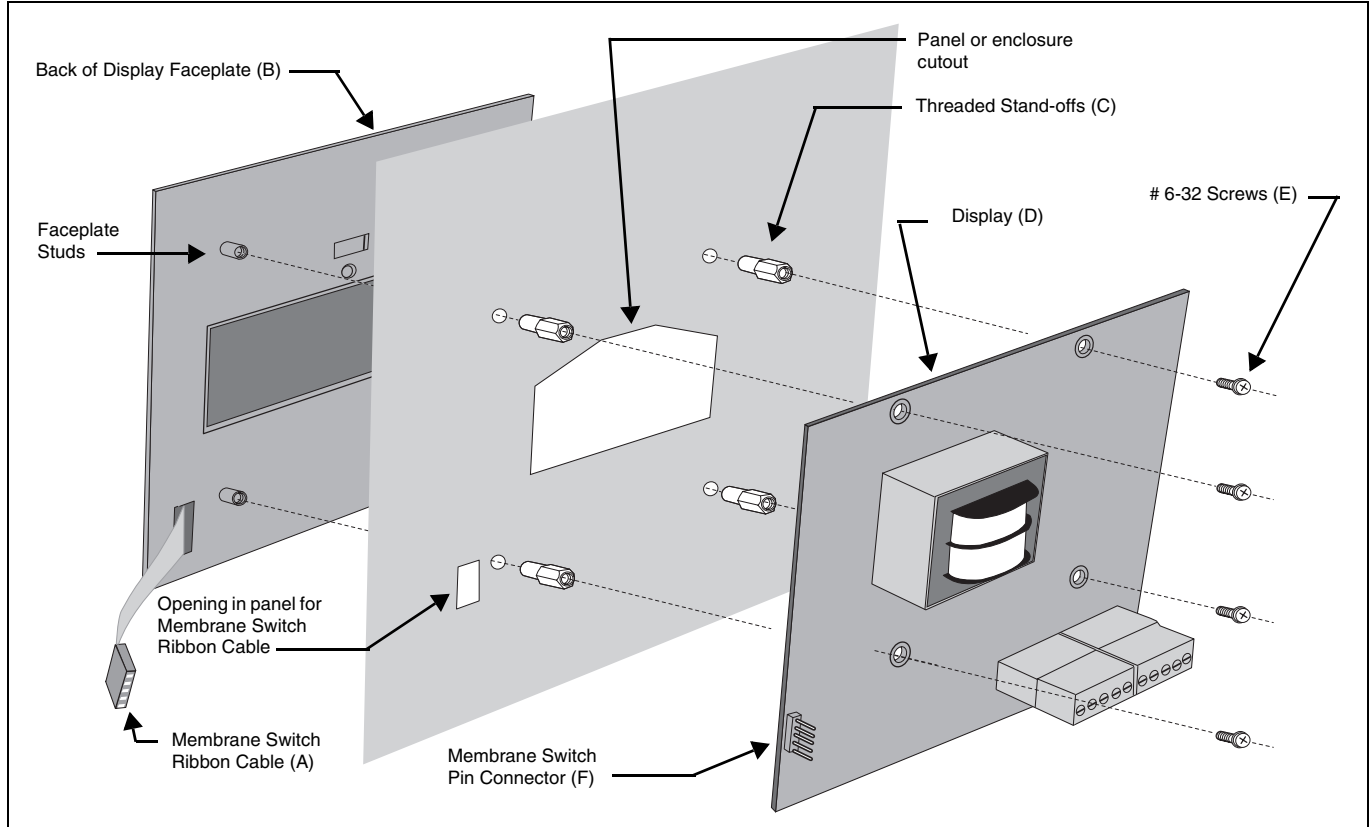

COMMUNICATIONS

The display resides on a Modbus network as a pass-through device (Figure 5 and Figure 6). It provides an upstream and downstream communication connection. This allows for flexible data retrieval as the upstream options include RS-232, RS-485, or Palm Handheld compatible IR. Figure 7 on page 8 shows the downstream and upstream wiring scheme.

Figure 5: Upstream monitoring network option

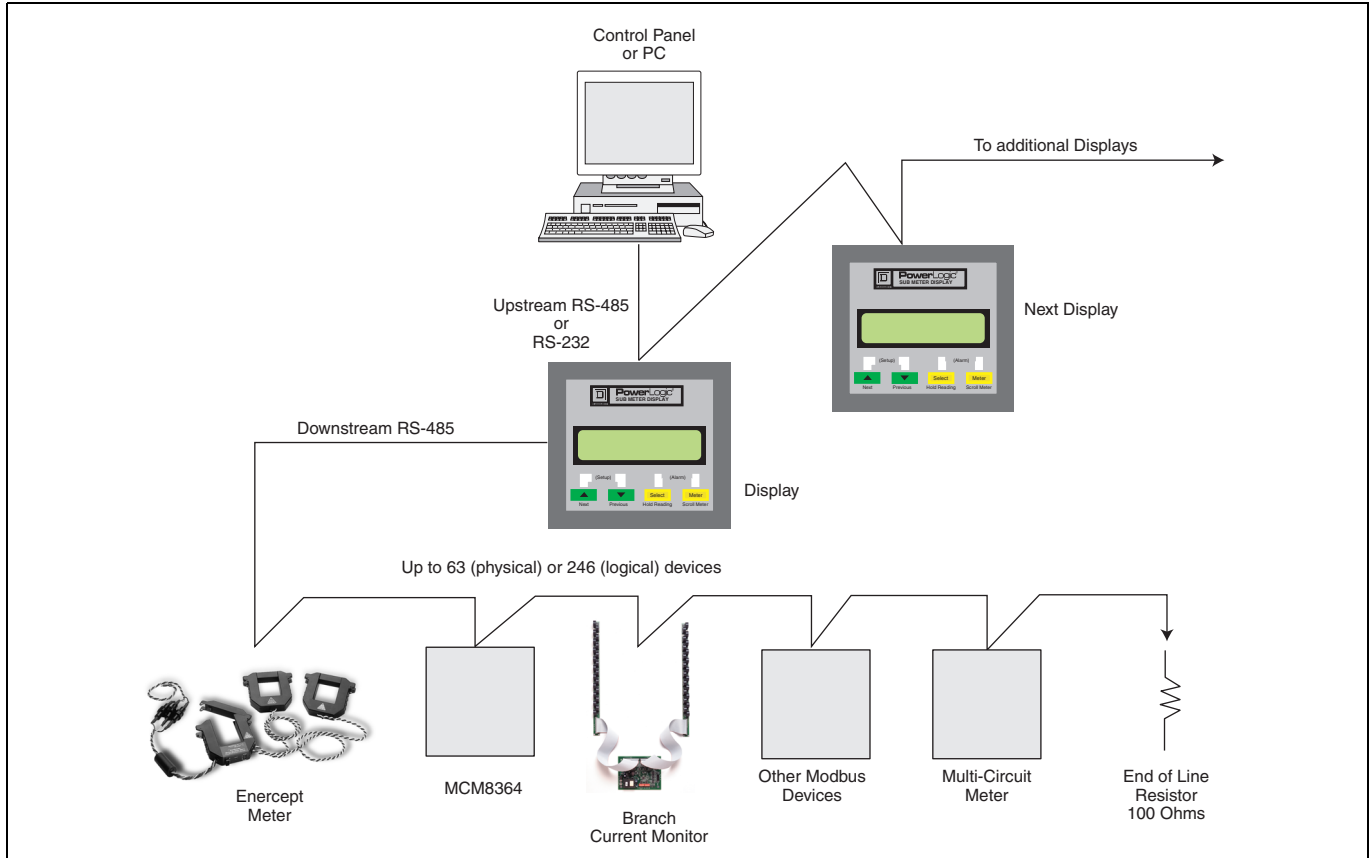
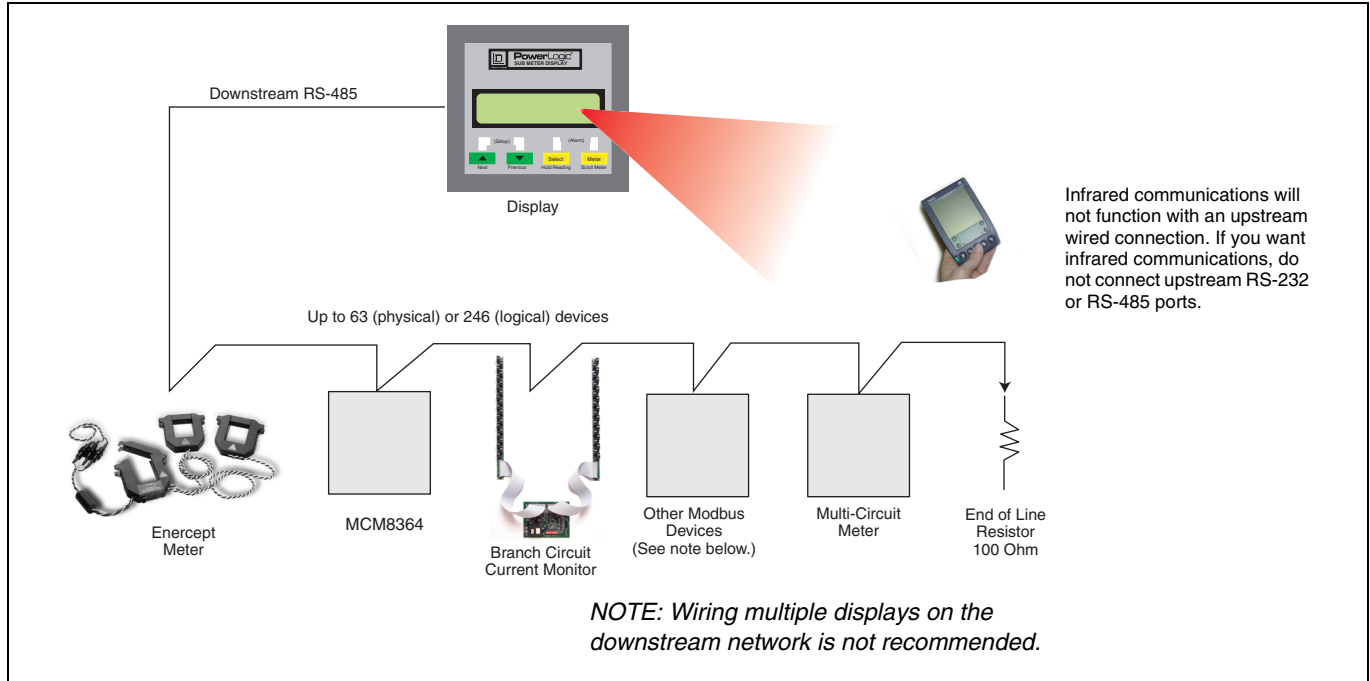

Figure 6: IR monitoring network option



Downstream Devices

Observe these guidelines for downstream devices communications wiring:

- Connect devices on a daisy chain from the downstream RS-485 port.
- The display can support 32 devices with a maximum distance of 4000 ft. (1,219 m) to the last device.
- For devices on the daisy chain, follow the device distance limitations recommended by the manufacturer.
- Each device must have a unique address.
- The last device must be terminated with a terminator (Square D part no. 3090MCTAS485 or 100 ohm resistor).

Upstream Devices

Observe these guidelines for upstream devices communications wiring:

NOTE: Connection to upstream RS-485 or RS-232 ports will disable the front infrared port.

- A master computer or additional Sub Meter Displays can be connected on a daisy chain to the upstream RS-485 port.
- The maximum distance from the first upstream device to the last is 4000 ft. (1,219 m).
- Each device on this upstream connection as well as those downstream must have a unique address.
- The last upstream device must be terminated with a terminator (Square D PN 3090MCTAS485 or 100 ohm resistor).

Figure 7: Wiring of downstream and upstream devices

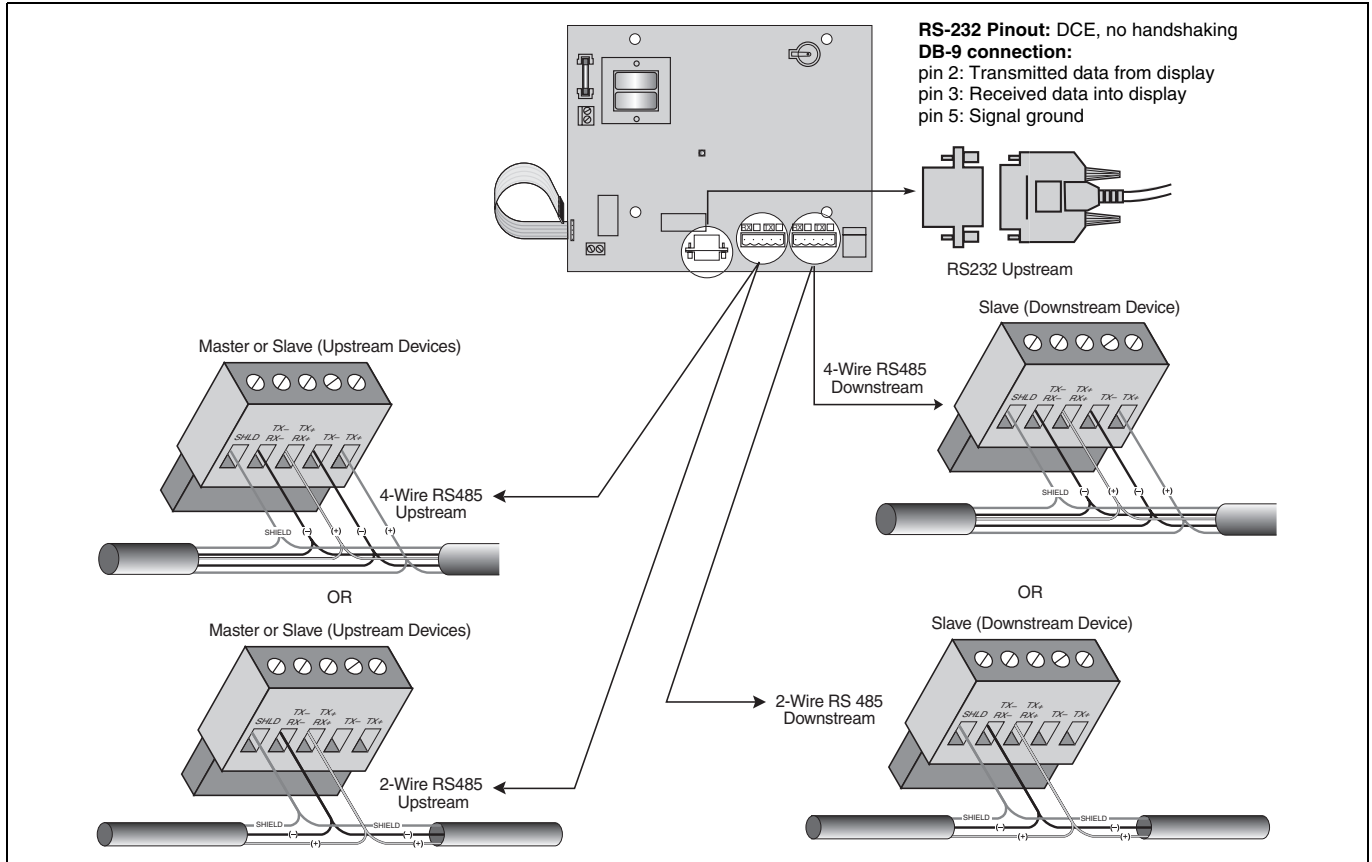

Terminating the Last Device in the Downstream Daisy Chain

Terminate the downstream network using the 3090MCTAS485 terminator to ensure reliable communications. Refer to Figure 8 and follow these steps:

1. Insert the wires of the daisy chain as shown in Figure 7 and insert the wires of the terminator into the holes of the RS-485 communications connector.
2. Using a small flat blade screwdriver, tighten the connector screws.
3. Plug the communications connector into the communications port of the last device on the daisy chain.

Figure 8: Installing the 3090MCTAS485 terminator

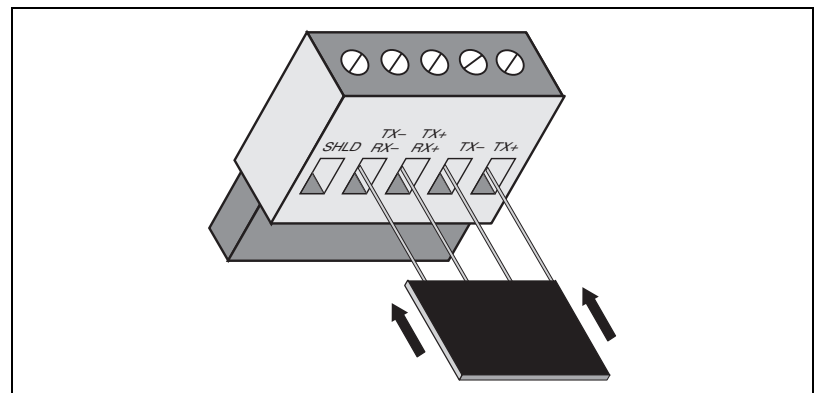

POWER CONNECTION

⚠ DANGER

HAZARD OF ELECTRIC SHOCK, EXPLOSION, OR ARC FLASH

- This equipment must be installed and serviced only by qualified personnel.
- Turn off all power supplying this equipment and the equipment it is mounted inside before working on or inside equipment.
- Always use a properly rated voltage sensing device to confirm that power is off.
- Replace all device doors and covers before turning on power to this equipment.

Failure to follow these instructions will result in death or serious injury.

To make the power connection, use either 120 Vac 2-wire or 12 Vdc connection as shown in Figure 9.

Figure 9: Power connection options

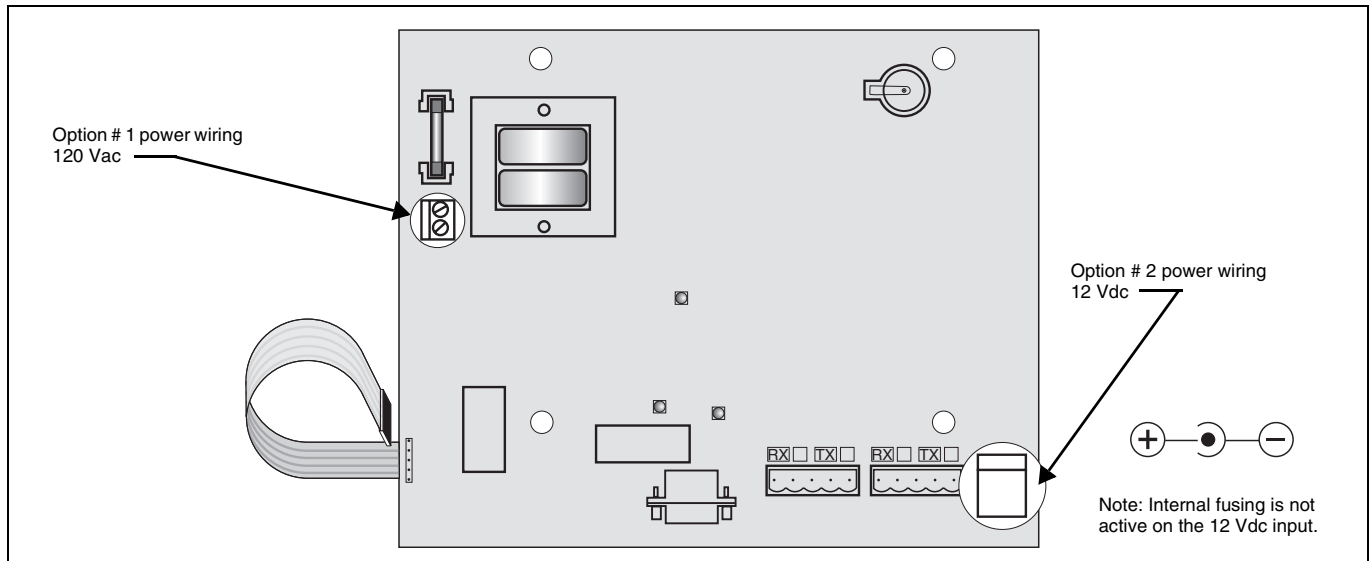

SETUP

Entering the Password

Use the Setup Mode to initialize and configure the display to the application requirements. The password for setup mode is "Select, Previous, Previous, Select, Next, Next" as shown in Figure 10. This password is fixed and cannot be changed.

Figure 10: Entering the password for setup mode

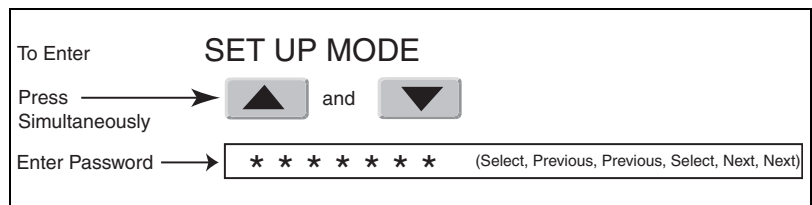

Initializing a System

To initialize a system, you must perform the Setup communications and Find Meters actions. See “Setup Communications Submenu” on page 11 and “Find Meters Submenu” on page 11.

Viewing the Setup Mode Submenus

Once you are in the setup mode, press Next or Previous buttons to view submenus and then press Select for the submenu you want. Figure 11 illustrates setup mode button functions.

Figure 11: Setup mode button functions

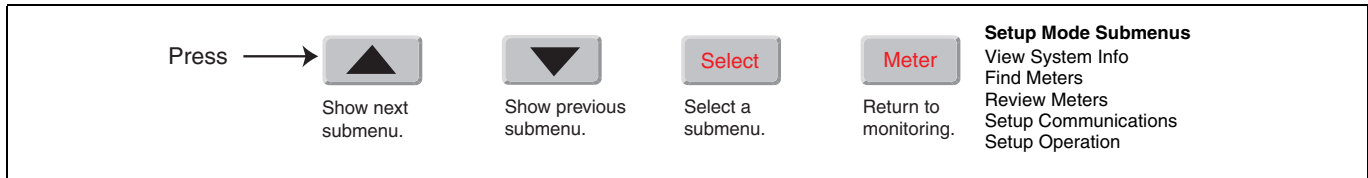

The following are the setup mode submenus:

View System Info Submenu

In setup mode, View System Info is the first submenu to display. Select “View System Info” for viewing information only (not modifying) such as the serial number or the customer support phone number. See Figure 12.

Figure 12: View system info button functions

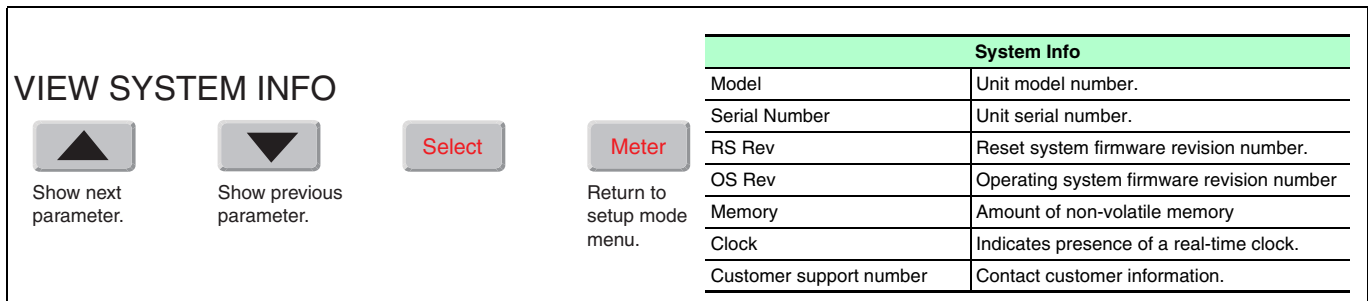

Setup Operation Submenu

Select “Setup Operation” to adjust operational parameters. Set backlight brightness for optimum visibility. You can set output relay and auxiliary input parameters based on the contact configuration of any (optional) remote devices. You can set the display to automatically rotate through the readings or you can rotate manually. See “Monitoring Mode” on page 12 for details. Refer to Figure 13 for Setup Operation parameters.

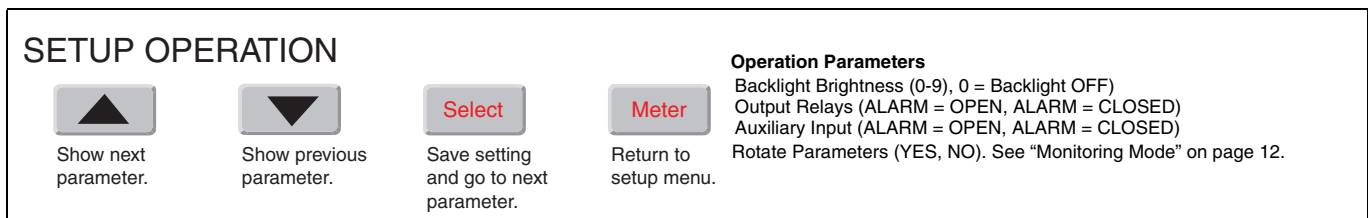

Figure 13: Setup operation button functions



Setup Communications Submenu

Select "Setup Communications" to adjust communications parameters. You must set downstream communications parameters to match the communications parameters of the downstream devices. When using an upstream master PC or control panel, you must set the appropriate Modbus address and upstream communications parameters. Refer to Figure 14.

Figure 14: Setup communication button functions

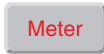
SETUP COMMUNICATIONS			
			
Show next parameter.	Show previous parameter.	Save setting and go to next parameter.	Return to setup menu.
Communication Parameters			
Modbus Address (1-247) Upstream Type (RS-485, RS-232, Infrared) Upstream Duplex (2-wire, 4-wire). See Notes 1, 2. Upstream Baudrate (2400, 4800, 9600, 19,200). See Note 2. Upstream Parity (NONE, ODD, EVEN). See Note 2. Downstream Duplex (2-wire, 4-wire) Downstream Baudrate (2400, 4800, 9600, 19,200) Downstream Parity (NONE, ODD, EVEN)			
Notes: 1. Parameter not available for RS-232. 2. Parameter not available for Infrared.			

Find Meters Submenu

From Setup mode, selecting "Find Meters" initiates a search and identifies devices on the network. Exit the search by pressing any key. To make sure all meters are accounted for, do not exit until all active addresses have been counted.

Unsupported devices will be designated as "unknown device" and parameters will not be displayed. See Table 3 on page 15 for supported devices.

Review Meters Submenu

From Setup mode, selecting "Review Meters" allows you to review all attached devices detected by the display. When you press REVIEW METERS, you see the first device found in the network. If the display does not detect any devices, you get a "No Meters" message. The following are example displays of devices detected by the FIND METERS function:

Example display for an MCM6384 meter:

```
AD=002 BRD1 MTR7  
MULTI-CRCT PRW 8
```

where AD=002 indicates Modbus address 2, BRD1 is the board name, and MTR7 is the meter name.

Example display for a BCM42 monitor:

```
AD=061 BRD1  
BRANCH CRCT AMPS
```

where AD=061 indicates Modbus address 061 and BRD1 is the board name.

Example display for an Alta RH/Temp sensor:

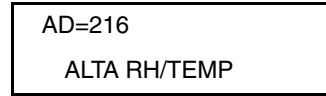

Example display for an unsupported device:

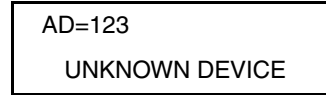

- Press Next to view the next meter. Continue pressing Next to scroll through the devices.
- Press Meter to return to the setup menu.

Monitoring Mode

Monitoring is the default mode for the Sub Meter Display. You can set up the display to automatically rotate (scroll) through parameters or you can set it to display a selected parameter continuously. You do this by selecting either Yes or No for “Rotate Parameters” in the Setup Operation submenu (see Figure 13 on page 10). When set to Yes for “Rotate Parameters,” the display automatically rotates through the parameters of all supported devices and updates every four seconds. You can press Select to hold a reading to allow time to manually record the reading. When the reading is in hold, it will not be updated. Press any other button to return to monitoring mode (the display resumes automatically rotating through parameters of all supported devices). Figure 15 shows the monitoring mode button functions.

Figure 15: Monitoring mode button functions

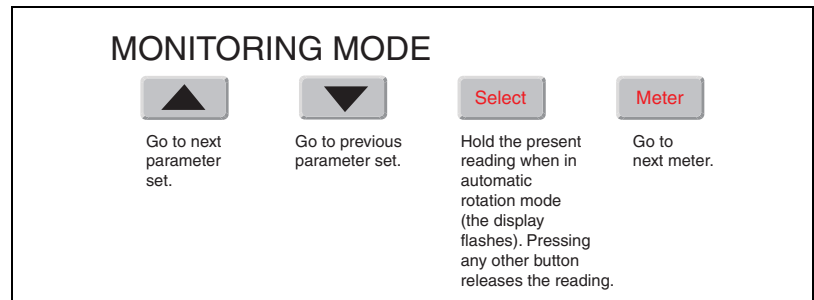

Viewing and Resetting Alarms

Alarm mode provides a means of viewing and resetting warning and critical alarms on the downstream network. To enter the alarm mode, press the Select and Meter buttons simultaneously. Figure 16 shows the alarm mode button functions.

Figure 16: Alarm mode button functions

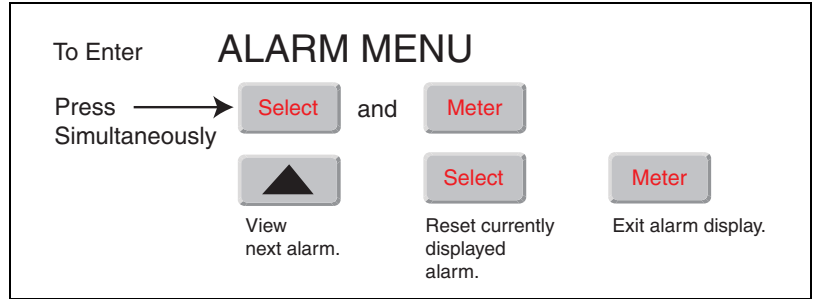

TROUBLESHOOTING AND MAINTENANCE

⚠ WARNING

HAZARD OF ELECTRIC SHOCK, EXPLOSION OR ARC FLASH

- Apply appropriate personal protective equipment (PPE) and follow safe electrical work practices. See NFPA 70E.
- Turn off all power supplying this equipment and the equipment it is mounted inside before working on or inside equipment.
- Always use a properly rated voltage sensing device to confirm that power is off.
- Replace onboard lithium backup battery only with the same or equivalent type recommended by the manufacturer.
- Dispose of battery according to the manufacturer's instructions.

Failure to follow this instruction can result in death or serious injury.

If the display does not illuminate, check the fuses and voltage connections.

Changing the Battery

To change the onboard lithium backup battery (item 2, Figure 2 on page 3), follow these steps:

1. Verify that the power supply to the display is turned off.
2. Remove the old lithium battery, taking care not to short the battery terminals.
3. Install the new lithium battery (same or equivalent type recommended by the manufacturer).
4. Turn on the power supply to the display.

Changing the Fuse

If the fuse is blown, use only 250 Vac / 200 mA, Fast, 5x20 mm. Follow these steps to replace it:

1. Verify that the power supply to the display is turned off.
2. Remove the old fuse and replace it with the new one.
3. Turn on the power supply to the display.

QUICK REFERENCE MENU TREE

Figure 17 provides a quick reference menu tree.

Figure 17: Quick reference menu tree

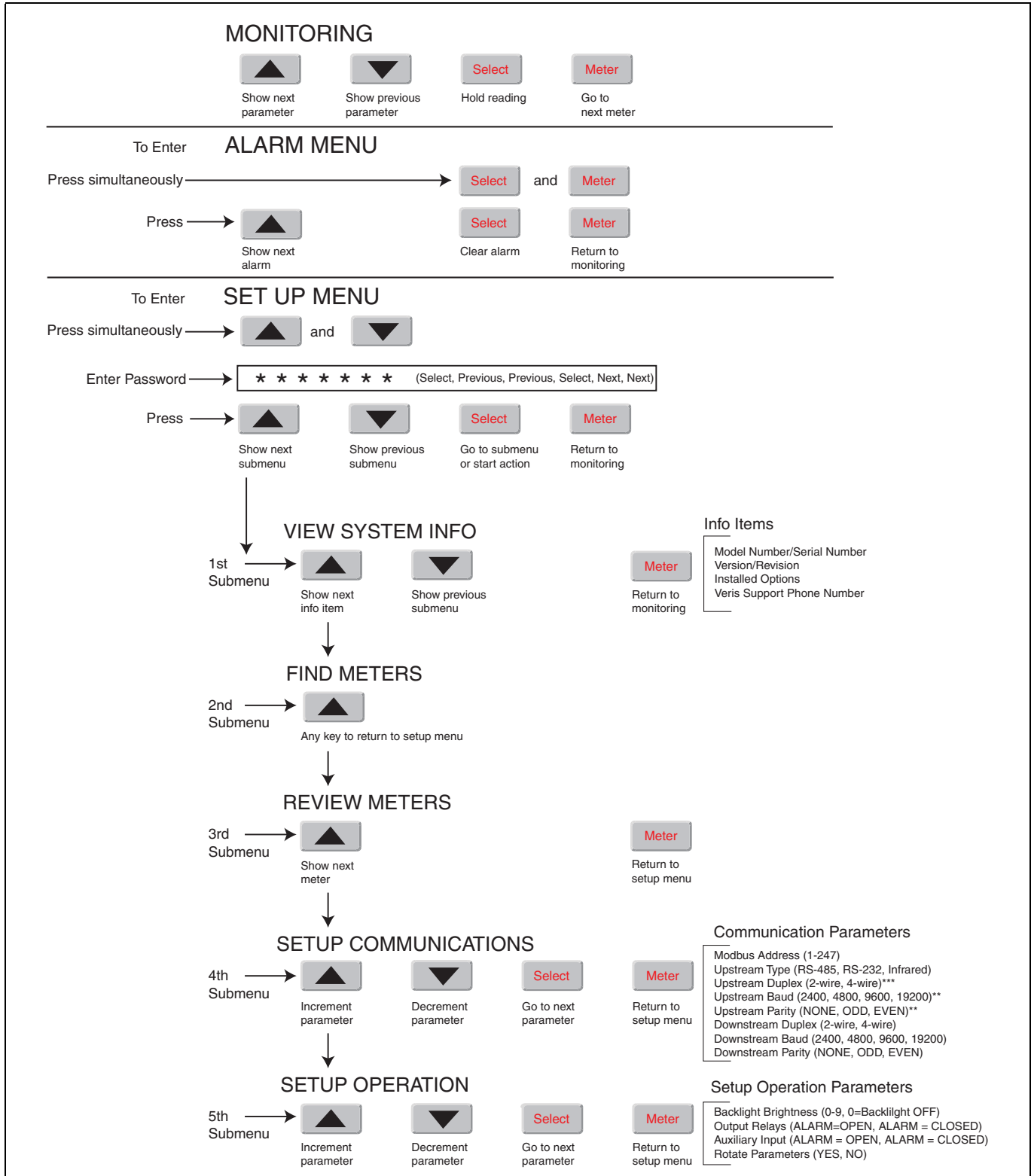

SPECIFICATIONS

Table 3: Specifications

Type	Description
General	
Operating Temperature Range	0 to 50°C (< 95% relative humidity, non-condensing)
Storage Temperature Range	-20°C to 70°C
AC Power Source	Dedicated 120 Vac, line-to-neutral, Fused, 200 mA at 250 Vac 5x20 mm Fast
AC Power Voltage Tolerance	+ 10/-25% (90-132 Vac)
AC Power Frequency	50/60 Hz
AC Power Termination	2-position cage clamp terminal block (max. wire size 12 gauge)
Alternate DC Power Source	12 Vdc unfused (Auxiliary input disabled)
Upstream Network Communications	
Interface	RS-485, RS-232, or infrared
Protocol	Modbus RTU
Baud Rate	User-selectable 2400, 4800, 9600, 19,200 (infrared fixed at 9600)
Parity	User-selectable NONE, ODD, EVEN (infrared fixed at NONE)
Communication Format	8-data-bits, 1-start-bit, 1-stop-bit
RS-485	1/4-load transceivers Duplex is user-selectable 2-wire or 4-wire 5-position depluggable connector
Infrared	Bi-directional (transmit and receive) 30-degree viewing angle, 12 inch nominal range IrDA 1.0 Physical Layer Compliant
Downstream Network Communications	
Interface	RS-485
Protocol	Modbus RTU
Duplex	User-selectable 2-wire or 4-wire
Load	1/4-load transceivers
Baud Rate	User-selectable 2400, 4800, 9600, 19,200
Parity	User-selectable NONE, ODD, EVEN
Communication Format	8-data-bits, 1-start-bit, 1-stop-bit
Termination	5-position depluggable connector
LCD	
Size	1 x 4 inch visible area, 2 lines x 16 characters per line
Backlight	Green, User-adjustable brightness in 10 steps
Supported Modbus Devices	
Enercept Meters	
Multi-Circuit Monitor (MCM8364)	
Branch Current Monitor (BCM42)	
Alta Labs Network Temperature/Humidity Sensors (HXO-485, TXO-485, HXO/T-485)	

ENGLISH

MOUNTING TEMPLATE

The following template may be used as a guide when installing the display.

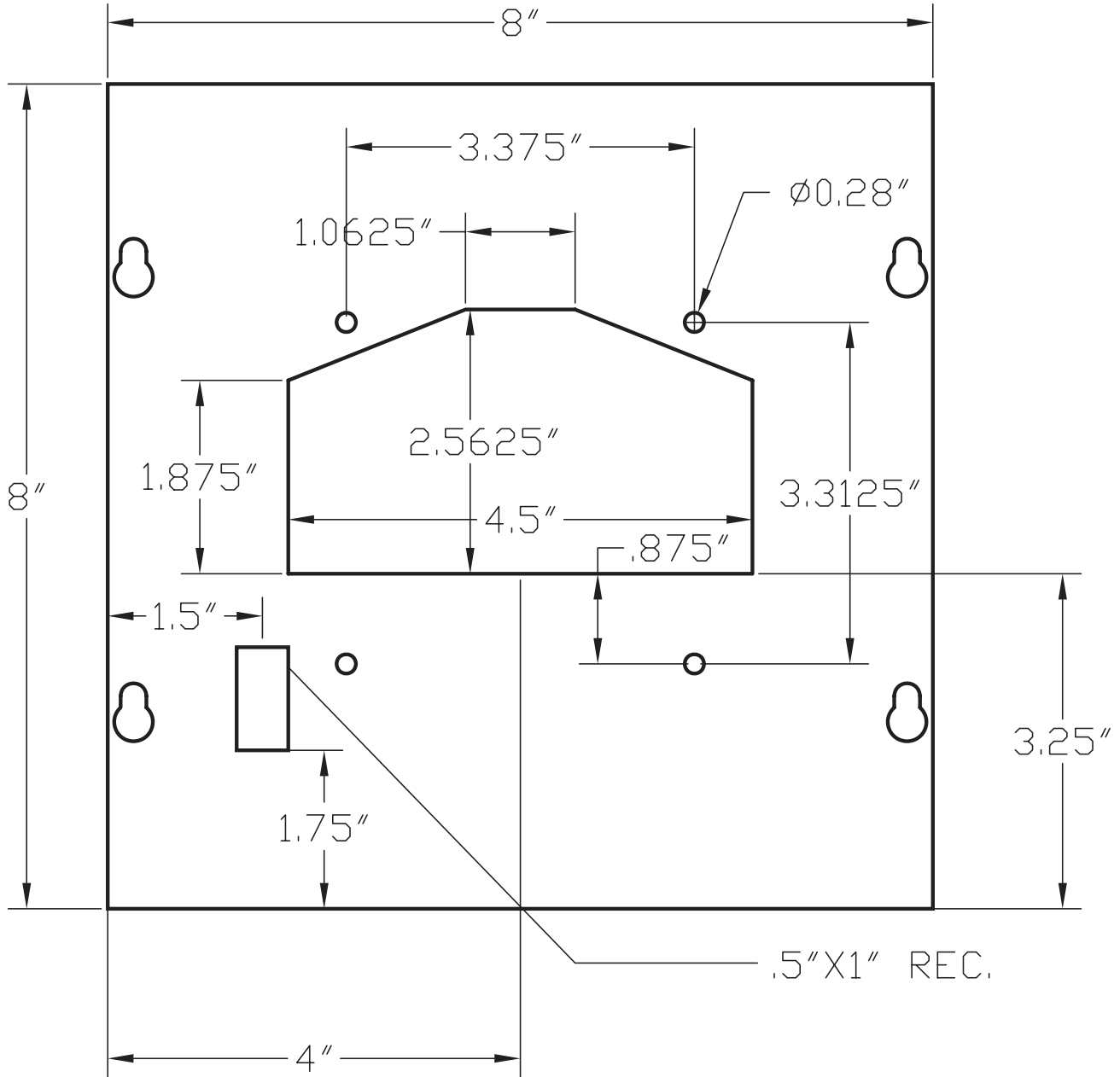

Schneider Electric
Power Monitoring and Control
295 Tech Park Drive, Suite 100
LaVergne, TN 37086
+1 (615) 287-3400
www.schneider-electric.com
www.powerlogic.com

Electrical equipment should be installed, operated, serviced, and maintained only by qualified personnel. No responsibility is assumed by Schneider Electric for any consequences arising out of the use of this material.

© 2006 Schneider Electric All Rights Reserved

